

Owner's Manual

POWERTEC

Planer Stand

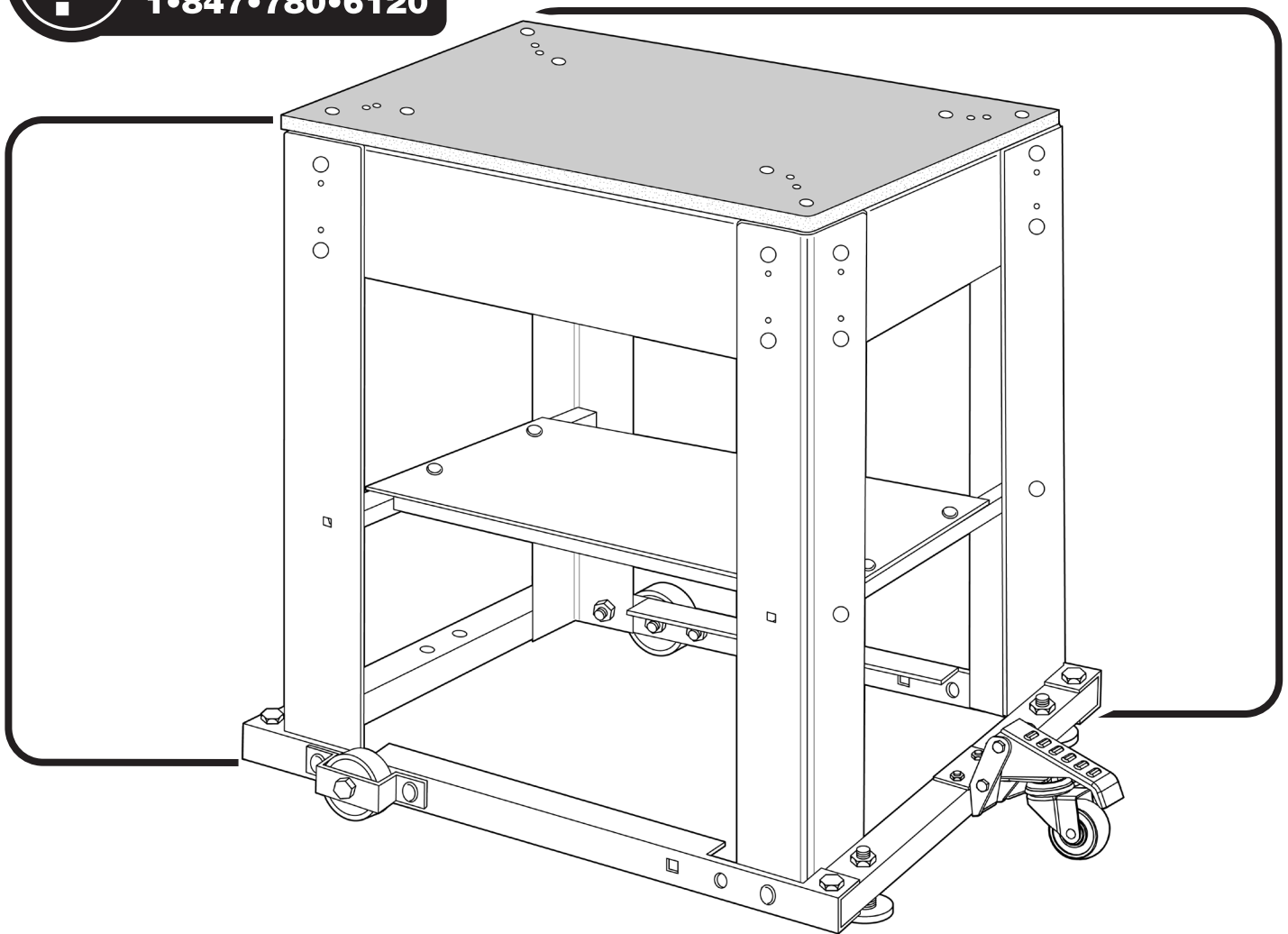

Visit us on the web at www.powertecproducts.com



You will need this manual for safety instructions, operating procedures, and warranty. Put it and the original sales invoice in a safe, dry place for future reference.

TABLE OF CONTENTS

SECTION PAGE



SAFETY RULES

1

Safety Rules



PARTS AND CONTENTS

2

Unpacking



ASSEMBLY

3-5

Assembly
Adjusting the Fence Faces



OPERATION

5

Operation



MAINTENANCE

5

General Maintenance



WARRANTY

6

Warranty

PRODUCT SPECIFICATIONS

Model No.	UT1008
Top (covered in Melamine)	23-1/16" x 20-1/8" (585.77 x 511.18 mm)
Height (with top)	29.5" (749.3 mm)
Shelf (steel)	23-7/16" x 15" (595.3 x 381 mm)
Foot Print (with caster mounted inboard)	26-3/4" x 24-7/8" (679.45 x 631.8 mm)
Pre-drilled mounting holes	13-3/4" x 18-1/8" (349.25 x 460.38 mm)
	12-11/16" x 17-5/8" (322.26 x 447.68 mm)
	11-7/16" x 15-3/16" (290.52 x 385.7 mm)
Shelf height	11-3/4" (298.45 mm)
Weight	53.3 lbs (24.2 kg)

SAFETY RULES



1

WARNING

For your own safety, read all of the rules and precautions before operating tool.

WARNING

- This product was designed to be used as a Planer Stand for planers. Do not overload. The maximum capacity for the Planer Stand is 300 lbs (136 kg).
- Do not use for scaffolding or as ladder. Do not stand or climb on the Planer Stand; it could tip over, causing serious injury.
- Do not apply an unbalanced load. This could cause the Planer Stand to tip over.
- Store the Planer Stand properly. Do not store the Planer Stand outdoor or in a damp location.
- Keep the work area clean, uncluttered, and well lit. Do not work on or place the Planer Stand legs on floor surfaces that are slippery from sawdust, oil, water or wax.
- Keep children and bystanders away while operating a power tool. Distractions may cause you to lose control. Visitors should wear the same safety equipment as the operator.
- Properly secure the planer to the Planer Stand before operation. Follow the mounting instructions carefully. Fasten the tool to the MDF top securely as instructed.
- Place the Planer Stand on a flat level surface to prevent rocking or tipping.
- Make sure the Planer Stand is firmly on the floor, the foot pedal is down and the wheel is raised before use.
- Always wear safety glasses or eye shields when operating power tools.
- Dress properly. Do not wear loose clothing or jewelry. Keep your hair, clothing and gloves away from moving parts. Loose clothes, jewelry or long hair can be caught in moving parts. Always wear non-slip footwear. Tie back long hair. Roll long sleeves above the elbow.
- Always use clamps or other practical ways to support the workpiece and secure it to a stable platform. Holding the workpiece by hand or against your body is unstable and may lead to loss of control.
- Check all hardware prior to mounting any bench top tools.
- Inspect all hardware periodically; tighten anything loose.
- Be sure to use the proper mounting bolts for the unit being attached to the Planer Stand.

WARNING

Do not modify this Planer Stand and/or use it for any application other than that for which it was designed.

WARNING

Always follow proper operating procedures as defined in this manual even if you are familiar with use of this Planer Stand or any tool used with this Planer Stand. Remember that being careless for even a fraction of a second can result in severe personal injury.

You must be familiar with the use of any tool or accessory used with this Planer Stand. The supplier cannot be held responsible for any accident, injury or damage incurred while using this Planer Stand with any tool.

FOLLOW ALL STANDARD SHOP SAFETY PRECAUTIONS, INCLUDING:

- Keep children and visitors at a safe distance from work area.
- Keep work area clean. Cluttered work areas invite accidents. Work area should be properly lit.
- Do not use power tools in dangerous environments. Do not use power tools in damp or wet locations. Do not expose power tools to rain.
- Wear proper apparel. Do not wear loose clothing, gloves, neckties, rings, bracelets or other jewelry which may get caught in moving parts of the tool.
- Wear protective hair covering to contain long hair.
- Wear safety shoes with non-slip soles.
- Wear safety glasses complying with United States ANSI Z87.1. Everyday glasses have only impact resistant lenses. They are NOT safety glasses.
- Wear face mask or dust mask if operation is dusty.
- Be alert and think clearly. Never operate power tools when tired, intoxicated or when taking medications that cause drowsiness.
- A guard or any other part that is damaged should be properly repaired or replaced. Do not perform makeshift repairs.
- Use the right tool for your job. Do not force your tool to do a job for which it was not designed.
- Use safety equipment such as featherboards, push sticks and push blocks, etc., when appropriate.
- Maintain proper footing at all times and do not overreach.
- Do not use this Planer Stand as a step or seat.

WARNING

- To avoid serious injury, turn off and unplug the planer before attaching or changing accessories or adjusting the cutter height position.

CAUTION

Think safety! Safety is a combination of operator common sense and alertness at all times when tool is being used.

WARNING

Do not use the Planer Stand until it is completely assembled and you have read and understood this entire operating manual and the operating manual of the tool being used with this Planer Stand.

SAVE ALL WARNINGS AND INSTRUCTIONS FOR FUTURE REFERENCE



1



PLANER STAND PARTS AND CONTENTS

UNPACKING Refer to Figure 1

- Your new Planer Stand is shipped complete in one carton. Contact the customer service center if any parts are missing.
- Examine shipping carton for freight damage before opening. If shipping carton is damaged file a claim with the carrier immediately.
- Carefully unpack all loose items from shipping carton and make sure all parts are accounted for.

ITEM	DESCRIPTION	QTY	ITEM	DESCRIPTION	QTY
A	Long Base Rails	2	J	Tie Bars	2
B	Short Base Rails	2	K	Shelf	1
C	Caster Assembly	1	L	Mdf Top (Covered In Melamine)	1
D	Wheels	2	M	5/16"-18 x 1-1/2" Flat Head Screws	4
E	Wheel Brackets	2	N	5/16"-18 x 2" Hex Head Bolts	6
F	Leveler Assemblies	2	O	5/16"-18 x 2-1/2" Hex Head Half Thread Bolts	2
G	Legs	4	P	5/16"-18 Nylon Lock Nuts	2
H	Short Upper Flanges Rails	2	Q	5/16"-18 x 5/8" Carriage Bolts	30
I	Long Upper Flanges Rails	2	R	5/16" Lock Washers	40
			S	5/16"-18 Nuts	40

Figure 1 Note: Reference Figure 1 as needed

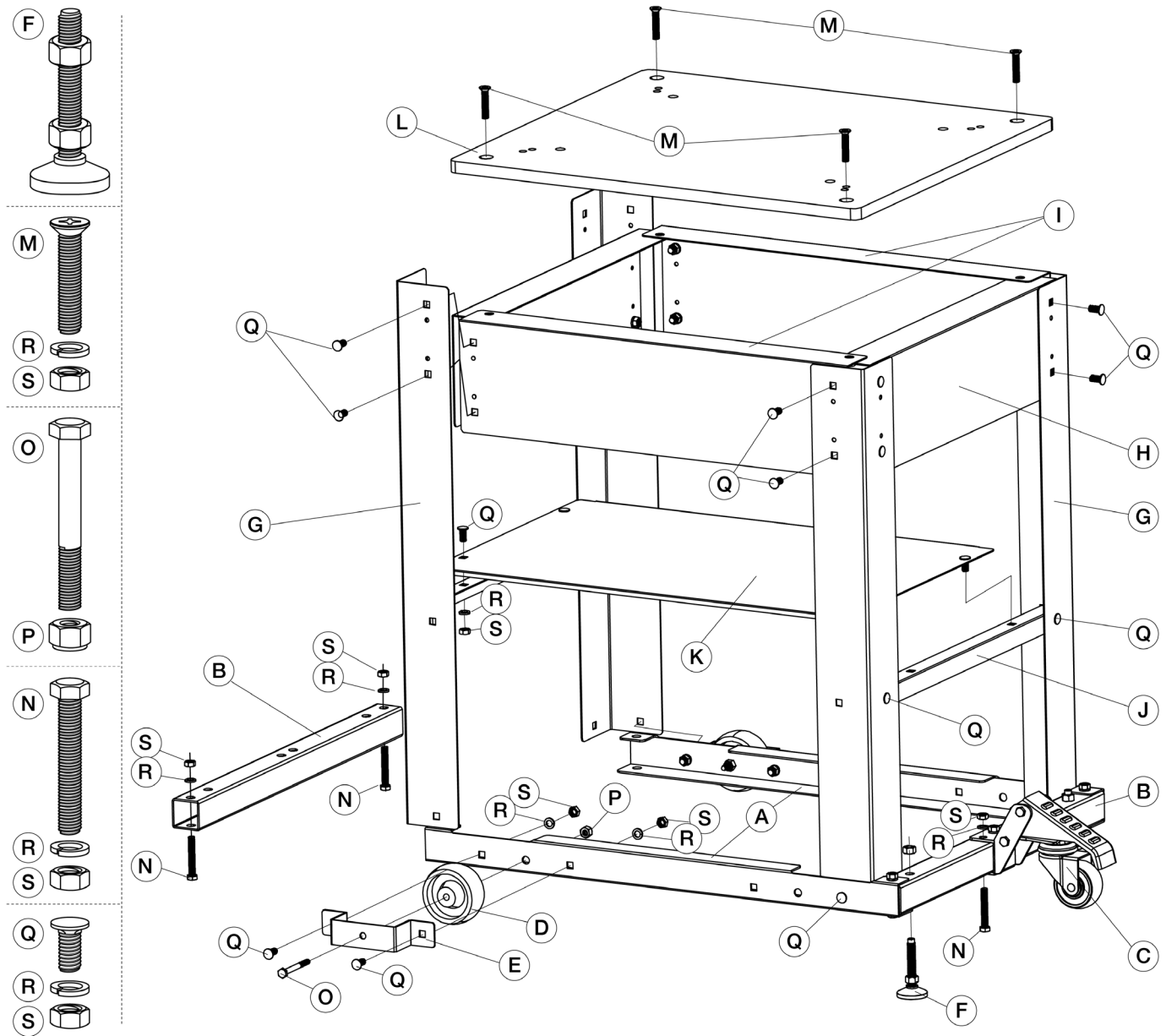

TOOLS NEEDED

- 5/8" and 1/2" open wrench or socket and socket wrench
- Hex head screw driver
- Square

WARNING

- Do not use the stand for scaffolding or as a ladder.
- Make sure to securely tighten all fasteners before using.
- Maximum capacity is **300 lbs (136 kg)**.

NOTE: Use a square to verify all of the components are perpendicular before fully tightening hardware.

BASE AND CASTER ASSEMBLY Items Needed

ITEM	DESCRIPTION	QTY
A	Long Base Rails	2
B	Short Base Rails	2
C	Caster Assembly	1
D	Wheels	2
E	Wheel Brackets	2
F	Leveler Assemblies	2
N	5/16"-18 x 2" Hex Head Bolts	6
O	5/16"-18 x 2-1/2" Hex Head Half Thread Bolts	2
P	5/16"-18 Nylon Lock Nuts	2
Q	5/16"-18 x 5/8" Carriage Bolts	2
R	5/16" Lock Washers	8
S	5/16"-18 Nuts	8

1. See Figure 2. Slide the Short Base Rails (B) into the Long Base Rails (A) aligning corners. Pay attention to location of the three holes in Long Base Rails (A) this will be the back. From the bottom, slide one 5/16"-18 x 2" Hex Head Bolt (N) through the corner holes on Long and Short rails. Repeat on all four corner holes. Secure each Hex Head Bolt (N) with one 5/16" Lock Washer (R) and one 5/16"-18 Nut (S). Tighten the hardware. Repeat for remaining two holes on Short Base Rail (B) in back location. This creates the frame base.

Figure 2

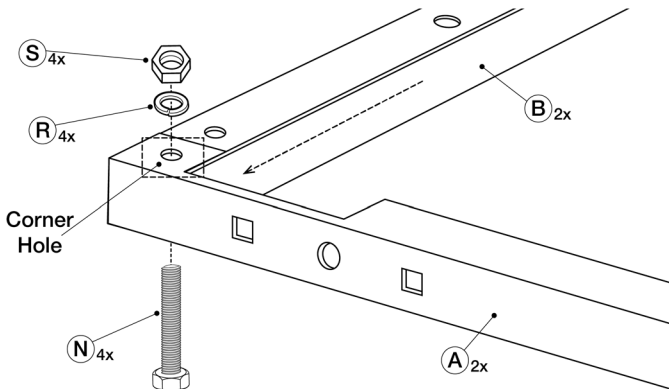

NOTE: The outside 5/16"-18 x 5/8" Carriage Bolts (Q) are used to attach the leg and wheel bracket to the frame base. Do this after the legs are attached.

2. See Figure 3. Center Wheel (D) inside Wheel Bracket (E). Align to side-holes on the Long Base Rail (A). Insert 5/16"-18 x 2-1/2" Hex Head Half Thread Bolt (O) through center round hole in Bracket (E), through Wheel (D) and into center round hole on Long Base Rail (A). Secure bolt with 5/16"-18 Nylon Lock Nut (P). Tighten the Lock Nut (P) until snug yet allowing the wheel to turn freely.

NOTE: Leave the left square hole of Bracket (E) open at this time.

3. Insert one 5/16"-18 x 5/8" Carriage Bolt (Q) through the right square hole in Bracket (E) and Long Base (A). Secure with Lock Washer (R) and Nut (S). Repeat for other side of frame base.

Figure 3

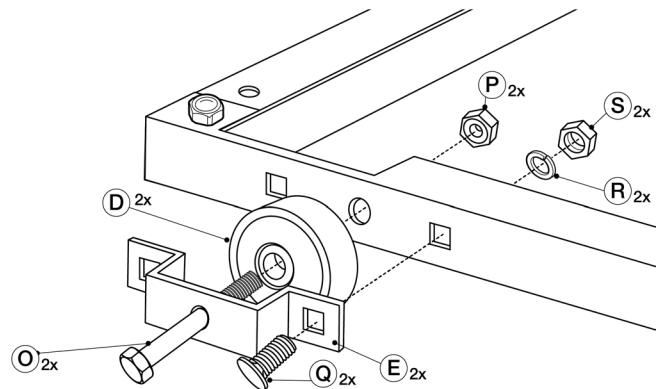

4. See Figure 4. Install the Leveler Assemblies (F) to the Short Base Rail (B) front, opposite the wheels. Remove one of the nuts from the threaded section of the leveler. Insert the Leveler Assembly (F) through the bottom of Short Base Rail (B) and secure with the removed nut. To adjust, see the **Adjust Leveler Assemblies** section.
5. The Caster Assembly (C) can be mounted inboard or outboard to the frame base (shown as outboard installation).
 - a. Align the holes on the Caster Assembly (C) with the holes on the Short Base Rail (B) frame.
 - b. Insert two Hex Head Bolts 5/16"-18 x 2" (N) through frame base and holes of the pedal.
 - c. Secure the pedal to Base Rail (B) by tightening with two 5/16" Lock Washers (R) and 5/16"-18 Nuts (S).

Figure 4

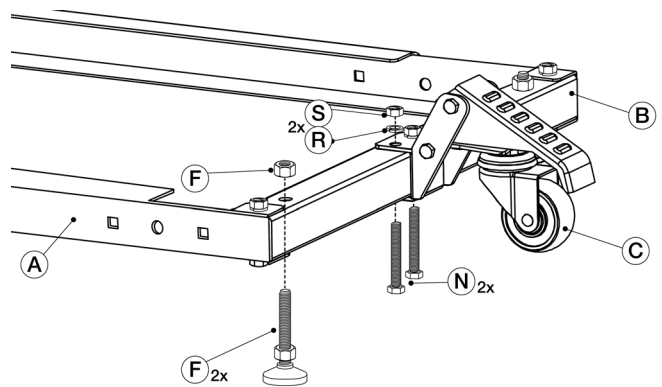

CAUTION

Tripping and/or other personal injury may result. Keep the planer stand out of walkways when the caster assembly pedal is in the outboard position on the stand.

STAND ASSEMBLY Items Needed

ITEM	DESCRIPTION	QTY
G	Legs	4
H	Short Upper Flanges Rails	2
I	Long Upper Flanges Rails	2
J	Tie Bars	2
Q	5/16"-18 x 5/8" Carriage Bolts	24
R	5/16" Lock Washers	24
S	5/16"-18 Nuts	24

1. See Figure 5. Place the assembled frame base in the upright position.
2. Position and attach the Legs (G) to the corners using four 5/16"-18 x 5/8" Carriage Bolts (Q), 5/16" Lock Washers (R) and 5/16"-18 Nuts (S). Tighten the hardware.

Figure 5

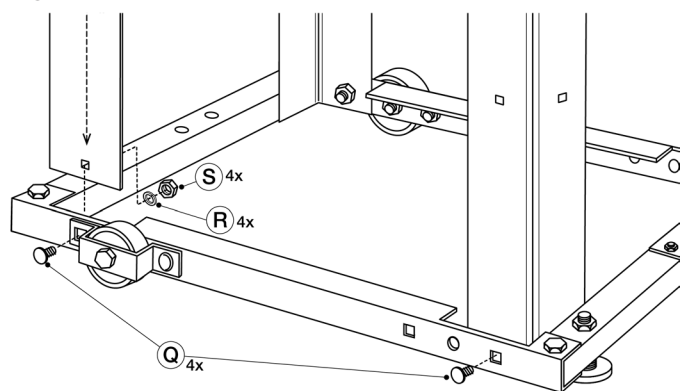

3. See Figure 6. Attach the Short upper flanges rails (H) to the inside of the legs (G) using eight 5/16"-18 x 5/8" Carriage Bolts (Q), 5/16" Lock Washers (R) and 5/16"-18 Nuts (S). Tighten the hardware. Be sure the holes in the sides are aligned with the locating divots provided.

Figure 6

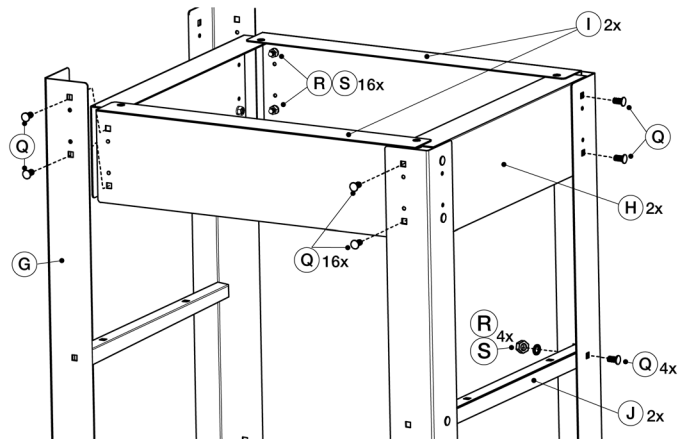

4. Attach the Long Upper flanges Rails (I) to the inside of the legs (G), overlapping the short sides, using eight 5/16"-18 x 5/8" Carriage Bolts (Q), 5/16" Lock Washers (R) and 5/16"-18 Nuts (S). Tighten the hardware. Be sure the holes in the sides are aligned with the locating divots provided.
5. Attach the Tie Bars (J) to the inside middle of the Legs (G) using four 5/16"-18 x 5/8" Carriage Bolts (Q), 5/16" Lock Washers (R) and 5/16"-18 Nuts (S). Tighten the hardware.

LOWER SHELF ASSEMBLY Items Needed

ITEM	DESCRIPTION	QTY
K	Shelf	1
Q	5/16"-18 x 5/8" Carriage Bolts	4
R	5/16" Lock Washers	4
S	5/16"-18 Nuts	4

1. See Figure 7. Position Shelf (K), lip down, aligning holes with those on the Tie Bars (J).
2. Insert four 5/16"-18 x 5/8" Carriage Bolts (Q) through the holes in the shelf and the tie brackets.
3. Secure the shelf with Lock Washers (R) and 5/16"-18 Nuts (S). Tighten the hardware.

Figure 7

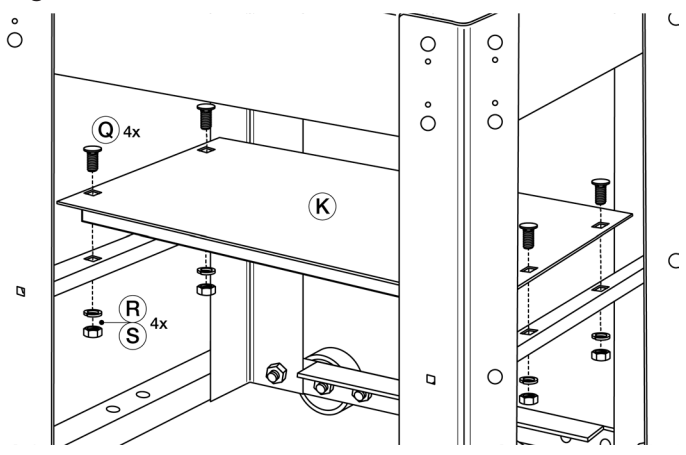

TOP ASSEMBLY Items Needed

ITEM	DESCRIPTION	QTY
L	Mdf Top (Covered In Melamine)	1
M	5/16"-18 x 1-1/2" Flat Head Screws	4
R	5/16" Lock Washers	4
S	5/16"-18 Nuts	4

See Figure 8. Attach the MDF top (L) to the Long upper flanges rails (I) using four 5/16"-18 x 1-1/2" Flat Head Screws (M), four each of 5/16" Lock Washers (R) and 5/16"-18 Nuts (S). Tighten the hardware.

Figure 8

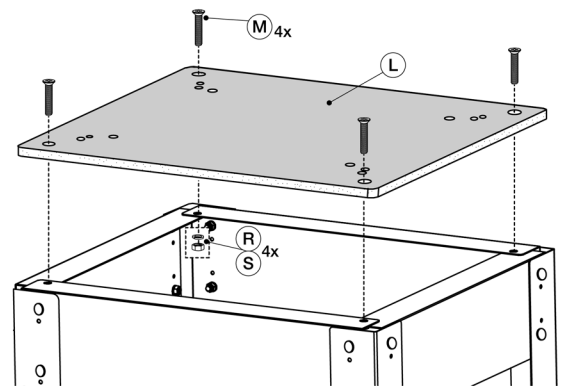

PLANER TO STAND

Planer Not Included. Refer to the planer manufacturer's instructions for recommended mounting hardware (sold separately)

Figure 9

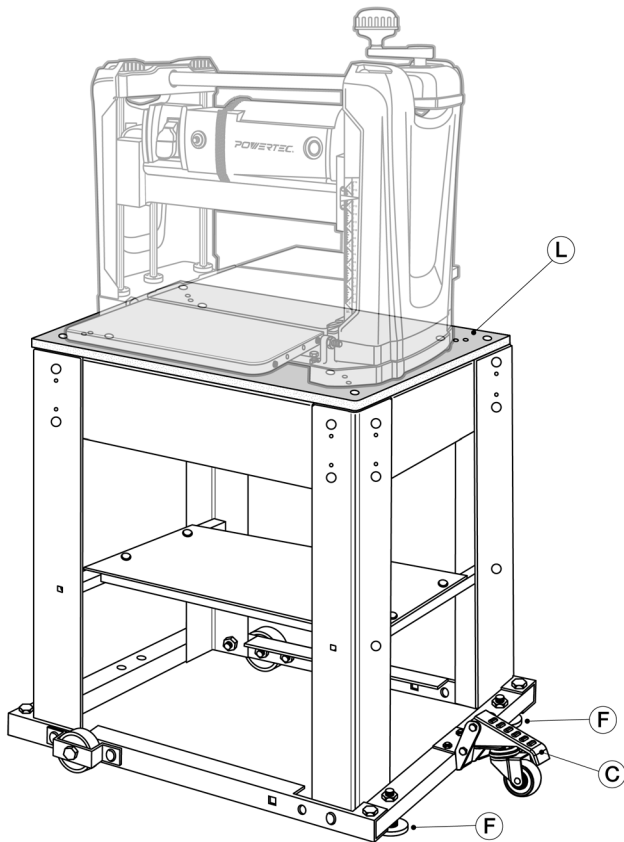

WARNING

STABILITY HAZARD. Refer to the planer manufacturer's instructions for securing the planer to a stand or supporting surface. Before operating secure the tool according to both the instructions in this manual and those in the planer manufacturer's manual. Failure to heed these warnings may result in serious personal injury and serious damage to the tool.

WARNING

To reduce the risk of injury, turn planer off, disconnect the tool from the power source before assembling the planer to the stand. An accidental start-up can cause injury.

WARNING

For your own safety, it is recommended that two people lift the planer or serious injury could result.

1. Turn the stand to the upright position.
2. Lift and place the planer on the MDF top (L).
3. Align holes in planer base with matching holes on MDF top.
4. Secure in place with recommended mounting hardware (sold separately)

If pre-drilled hole pattern does not match the planer:

The MDF Top is predrilled with three sets of holes, 13-3/4" x 18- 1/8", 12-11/16" x 17-5/8", and 11-7/16" x 15-3/16". If your planer will not fit any set, simply mark and drill new ones.

WARNING

Serious injury could result. Center the planer on the stand. Failure to center the planer could lead to an unstable assembly.

CAUTION

Be careful not to drill into the flanges when drilling holes.

1. Lift and place the planer on the MDF top (L).
2. Mark the placement of the holes on the MDF top.
3. Drill marked holes in the MDF top.
4. Align holes in planer base with matching holes on MDF top.
5. Secure in with recommended mounting hardware (sold separately)

IMPORTANT: The planer **MUST** be bolted squarely to MDF top.

Adjust Leveler Assemblies

Use Leveler Assemblies (F) for additional support on uneven floors.

1. Loosen the two nuts on one of the leveler assemblies.
2. Hold the nuts with a wrench and turn the foot until it is extended or retracted to the level required.
3. Re-tighten the bolts.
4. Repeat for the other leveler assemblies.

NOTE: After unit is assembled dispose of all packaging material in an environmentally safe way.

APPLICATIONS

WARNING

- Do not use the stand for scaffolding or as a ladder.
- Make sure to securely tighten all fasteners before using.
- Maximum capacity is **300 lbs (136 kg)**.

CAUTION

Always use caution when moving the planer stand. Debris encountered on the floor or other irregularities in the path of travel could cause the wheels to stop suddenly and cause the stand to tip.

1. Step on to depress Caster Assembly (C) foot pedal to unlock and lift stand.
2. Firmly grasp the handles on the planer and carefully move the stand to the desired location.
3. Push the foot pedal up, dropping the frame base into the locked position. The planer is now ready to use.

GENERAL MAINTENANCE

WARNING

When servicing, use only identical replacement parts. Use of any other parts may create a hazard or cause product damage. To ensure safety and reliability, all repairs should be performed by a qualified service technician.

WARNING

Keep the Planer Stand dry, clean, and free from oil and grease. Always use a clean cloth when cleaning. Never use brake fluids, gasoline, petroleum-based products or any strong solvent to clean the Planer Stand. Chemicals can damage, weaken or destroy plastic which may result in serious personal injury.

Always use caution when moving the planer stand. Debris on the floor or other irregularities in the path of travel could cause the wheels to stop suddenly and cause the stand to tip.

WARRANTY

Thank you for investing in a **POWERTEC** power tool. This product has been designed and manufactured to meet high quality standards and is guaranteed for domestic use against defects in workmanship or material for a period of 12 months from the date of purchase. This guarantee does not affect your statutory rights.

SOUTHERN TECHNOLOGIES LLC. BENCH TOP AND STATIONARY POWER TOOL LIMITED 1 YEAR WARRANTY AND 30-DAY SATISFACTION GUARANTEE POLICY

POWERTEC products are designed and manufactured by **Southern Technologies LLC**. All warranty communications should be directed to **Southern Technologies LLC** by calling 847-780-6120 (toll free), 9 AM to 5 PM, Monday through Friday, US Pacific Time.

30- DAY SATISFACTION GUARANTEE POLICY

During the first 30 days after the date of purchase, if you are dissatisfied with the performance of this **POWERTEC** tool for any reason, you may return the tool to the retailer from which it was purchased for a full refund or exchange. You must present proof of purchase and return all original equipment packaged with the original product. The replacement tool will be covered by the limited warranty for the balance of the one year warranty period.

LIMITED ONE YEAR WARRANTY

This warranty covers all defects in workmanship or materials in this **POWERTEC** tool for a one year period from the date of purchase. This warranty is specific to this tool. **Southern Technologies, LLC** reserves the right to repair or replace the defective tool, at its discretion.

HOW TO OBTAIN SERVICE

To obtain service for this **POWERTEC** tool you must return it, freight prepaid, to **POWERTEC**. You may call (toll free) 847-780-6120 for more information. When requesting warranty service, you must present the proof of purchase documentation, which includes a date of purchase. **POWERTEC** will either repair or replace any defective part, at our option at no charge to you. The repaired or replacement unit will be covered by the same limited warranty for the balance of one year warranty period.

WHAT IS NOT COVERED

This warranty applies to the original purchaser at retailer and may not be transferred.

This warranty does not cover consumable items such as saw blades, knives, belts, discs, cooling blocks, and sleeves. This warranty does not cover required service and part replacement resulting from normal wear and tear, including accessory wear.

This warranty does not cover any malfunction, failure or defect resulting from:

- 1) Misuse, abuse, neglect and mishandling not in accordance with the owner's manual.
- 2) Damage due to accidents, natural disasters, power outage, or power overload.
- 3) Commercial or rental use.
- 4) Alteration, modification or repair performed by persons not recommended by **POWERTEC**.

DISCLAIMER

To the extent permitted by applicable law, all implied warranties, including warranties of MERCHANTABILITY or FITNESS FOR A PARTICULAR PURPOSE, are disclaimed. Any implied warranties, that cannot be disclaimed under state law are limited to one year from the date of purchase. **Southern Technologies LLC** is not responsible for direct, indirect, incidental or consequential damages. Some states do not allow limitations on how long an implied warranty lasts and/or do not allow the exclusion or limitation of incidental or consequential damages, so the above limitations may not apply to you. This warranty gives you specific legal rights, and you may also have other rights which vary from state to state. Southern Technologies LLC., makes no warranties, representations, or promises as to the quality or performance of its power tools other than those specifically stated in this warranty.

POWERTEC[®]

Southern Technologies LLC • Chicago • IL 60606