

INSTRUCTION SHEET

POWERTEC®

ADJUSTABLE ROUTER TABLE STAND

Model No. UT1006



THINGS TO KNOW

- footprint/top – 20-9/16" x 28-7/16"
- height range with adjustable feet – 30-3/16" – 34-3/8"
- height range with levelers – 31-1/8" – 36-3/8"
- a shelf can be added to the lower tie bars
- mounting holes are located in the legs for remote switch assembly
- for mobility, the included levelers can be removed and casters (17201, not included) can be added

CAUTION

Do not modify or use this stand for any application other than that for which it was designed.

CAUTION

Load Capacity Limit: DO NOT exceed maximum load rating of 400 lbs. [181 kg.]. If casters have been installed, do not exceed 400 lbs. [181 kg.] or the load rating of the casters, whichever is less.

PACKAGING CONTENTS

ITEM	DESCRIPTION	QTY
A	Legs (29-1/2" x 1-15/16" x 1-15/16")	4
B	Long tie bars (27-3/8" x 2-3/4" x 3/4")	4
C	Short tie bars (19-1/2" x 2-3/4" x 3/4")	4
D	Adjustable feet	4
E	Levelers (each leverer has two flange nuts and two washers)	4
F	5/16"-18 x 5/8" carriage bolts	48
G	5/16" lock washers	48
H	5/16"-18 nuts	48

Figure 1

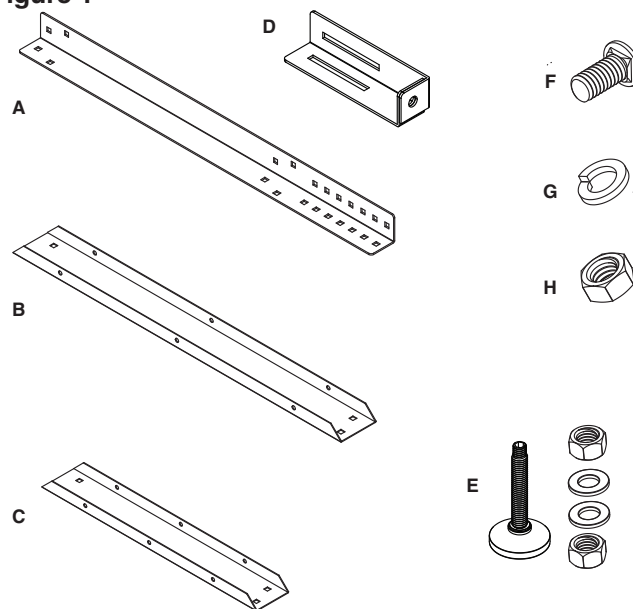

ASSEMBLY

1. Use eight 5/16"-18 x 5/8" carriage bolts (F), eight 5/16" lock washers (G) and eight 5/16"-18 nuts (H) to assemble two legs (A) and two long tie bars (B). Make sure the rails on the bars are to the inside of the legs. FINGER TIGHTEN ONLY. Assemble the other two legs (A) and two long tie bars (B).
2. Attach the two leg/long tie bar assemblies to the short tie bars using sixteen 5/16"-18 x 5/8" carriage bolts (F), sixteen 5/16" lock washers (G) and sixteen 5/16"-18 nuts (H). FINGER TIGHTEN ONLY.

Figure 2

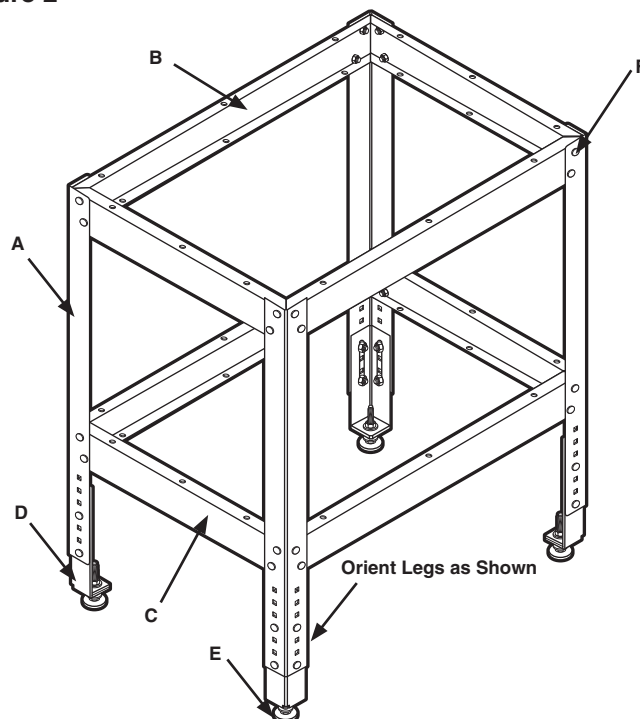

3. Place the entire assembly, upside down on a flat work surface
4. Square the long tie bars to the legs and tighten all nuts.

Figure 3

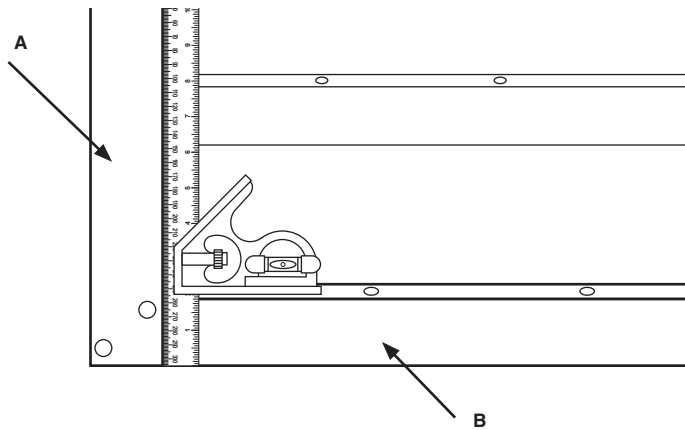

5. Square the short tie bars to the legs and tighten all nuts.

Figure 4

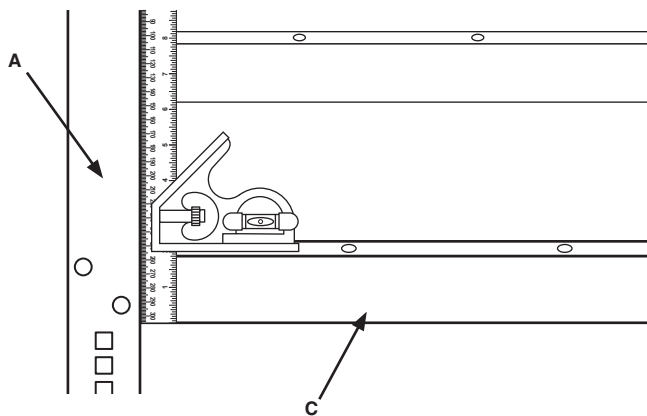

6. Determine the height of your completed stand and position a foot (D) inside each leg (A) at the appropriate hole location. Fasten each foot with four 5/16"-18 x 5/8" carriage bolts (F), four 5/16" lock washers (G) and four 5/16"-18 nuts (H).

Figure 5

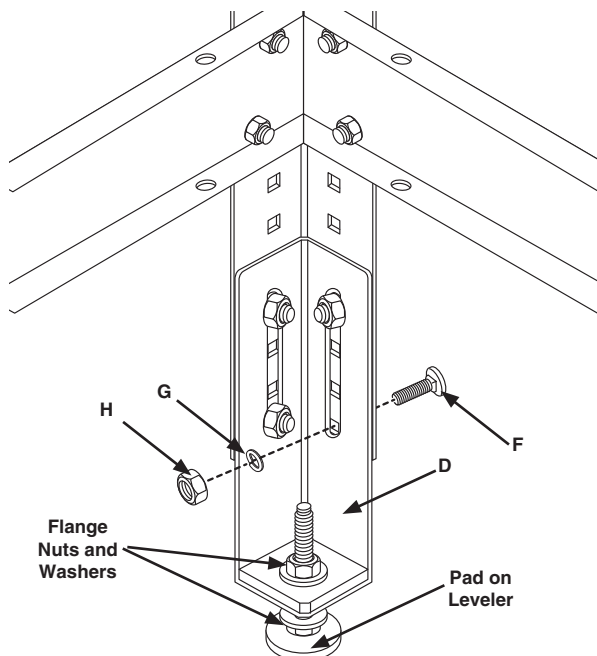

7. Remove a flange nut and washer from each leveler (E). Make sure the flange nut left on the leveler is about 1/4" from the pad on the leveler. Thread one leveler (E) through the bottom of each foot (D). Place the washer and flange nut back onto the leveler and finger tighten.
8. Place the bench top (not supplied) face down on the work surface. Center the upside down stand on to the bench top. Use 3/4" wood screws (not supplied, for best results use a #10 pan head wood screw with washer) to attach the bench top to the stand. Drive the wood screws through the holes in the top flanges on the tie bars and into the bench top. Turn the bench upright. **IMPORTANT:** Make sure the thickness of your bench top accommodates the 3/4" long screws.
9. Adjust the levelers: Loosen the top flange nut, hold the hex shank on the leveler stud with one wrench and turn the bottom flange nut up or down as needed with a second wrench. With all levelers adjusted, tighten the top flange nuts.

NOTE: For mobility replace the included levelers with casters 17201, not included. Figure 6 shows the 17201 casters assembled.

Figure 6

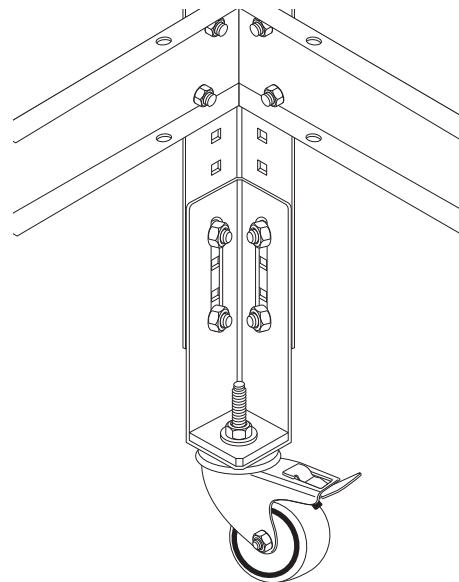

Visit us on the web at www.powertecproducts.com



Put these instructions and the original sales invoice in a safe, dry place for future reference.

Southern Technologies, LLC
Chicago, IL 60606