

Owner's Manual

POWERTEC®

Multi-Functional Project Table

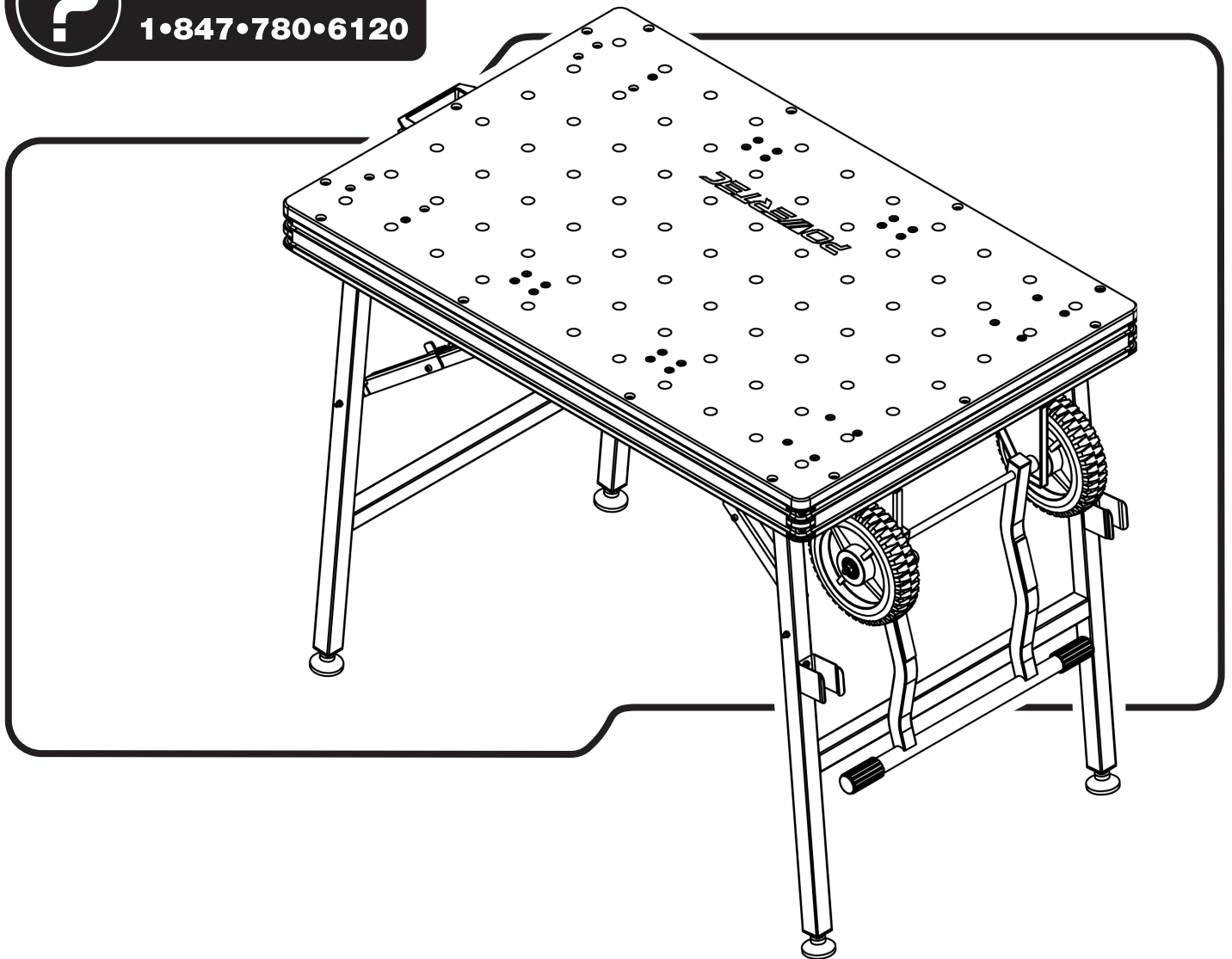

Visit us on the web at www.powertecproducts.com



You will need this manual for safety instructions, operating procedures, and warranty. Put it and the original sales invoice in a safe, dry place for future reference.

TABLE OF CONTENTS

PRODUCT SPECIFICATIONS

SECTION PAGE

Overall Dimensions:47.95" x 28.35" x 33.46"

Table Size:43.31" x 28.35" x 0.71"

Working Height:33.46"

Maximum Weight Limit:352 lb / 160 kg



SAFETY RULES

3

Safety Rules



ASSEMBLY

4-5

Unpacking



OPERATION

5-6

Operation



MAINTENANCE

6

General Maintenance



PARTS LIST AND BREAKDOWN 7

Parts List and Parts Breakdown



WARRANTY

8

Warranty

WARNING

For your own safety, read all of the rules and precautions before operating tool.

WARNING

This product was designed to be used as a Project Table. Do not overload. The maximum capacity for the Project Table is **352 lb / 160 kg**.

- Do not use for scaffolding or as ladder. Do not stand or climb on the Project Table; it could tip over, causing serious injury.
- Do not apply an unbalanced load. This could cause the Project Table to tip over.
- Store the Project Table properly. Do not store the Project Table outdoor or in a damp location.
- Keep the work area clean, uncluttered, and well lit. Do not work on or place the Project Table legs on floor surfaces that are slippery from sawdust, oil, water or wax.
- Keep children and bystanders away while operating a power tool. Distractions may cause you to lose control. Visitors should wear the same safety equipment as the operator.
- For any product used on this Project Table—Follow the manufacturers mounting instructions carefully. Fasten the tool to the MDF top securely as instructed by manufacturer.
- Place the Project Table on a flat level surface to prevent rocking or tipping.
- Make sure the Project Table is firmly on the floor, the foot pedal is down and the wheel is raised before use.
- Always wear safety glasses or eye shields when operating power tools.
- Dress properly. Do not wear loose clothing or jewelry. Keep your hair, clothing and gloves away from moving parts. Loose clothes, jewelry or long hair can be caught in moving parts. Always wear non-slip footwear. Tie back long hair. Roll long sleeves above the elbow.
- Always use clamps or other practical ways to support the workpiece and secure it to a stable platform. Holding the workpiece by hand or against your body is unstable and may lead to loss of control.
- Check all hardware prior to mounting any bench top tools.
- Inspect all hardware periodically; tighten anything loose.
- Be sure to use the proper mounting bolts for the unit being attached to the Project Table.

WARNING

Always follow proper operating procedures as defined in this manual even if you are familiar with use of this Project Table or any tool used with this Project Table. Remember that being careless for even a fraction of a second can result in severe personal injury.

You must be familiar with the use of any tool or accessory used with this Project Table. The supplier cannot be held responsible for any accident, injury or damage incurred while using this Project Table with any tool.

WARNING

Do not modify this Project Table and/or use it for any application other than that for which it was designed.

FOLLOW ALL STANDARD SHOP SAFETY PRECAUTIONS, INCLUDING:

- Keep children and visitors at a safe distance from work area.
- Keep work area clean. Cluttered work areas invite accidents. Work area should be properly lit.
- Do not use power tools in dangerous environments. Do not use power tools in damp or wet locations. Do not expose power tools to rain.
- Wear proper apparel. Do not wear loose clothing, gloves, neckties, rings, bracelets or other jewelry which may get caught in moving parts of the tool.
- Wear protective hair covering to contain long hair.
- Wear safety shoes with non-slip soles.
- Wear safety glasses complying with United States ANSI Z87.1. Everyday glasses have only impact resistant lenses. They are NOT safety glasses.
- Wear face mask or dust mask if operation is dusty.
- Be alert and think clearly. Never operate power tools when tired, intoxicated or when taking medications that cause drowsiness.
- A guard or any other part that is damaged should be properly repaired or replaced. Do not perform makeshift repairs.
- Use the right tool for your job. Do not force your tool to do a job for which it was not designed.
- Use safety equipment such as featherboards, push sticks and push blocks, etc., when appropriate.
- Maintain proper footing at all times and do not overreach.
- Do not use this Project Table as a step or seat.

WARNING

To avoid serious injury, turn off and unplug the planer before attaching or changing accessories or adjusting the cutter height position.

CAUTION

Think safety! Safety is a combination of operator common sense and alertness at all times when tool is being used.

WARNING

Do not use the Project Table until it is completely assembled and you have read and understood this entire operating manual and the operating manual of the tool being used with this Project Table.

SAVE ALL WARNINGS AND INSTRUCTIONS FOR FUTURE REFERENCE

4 MULTI-FUNCTIONAL PROJECT TABLE PARTS AND CONTENTS

UNPACKING Refer to Figure 1

- Your new Project Table is shipped complete in one carton. Contact the customer service center if any parts are missing.
- Examine shipping carton for freight damage before opening. If shipping carton is damaged file a claim with the carrier immediately.
- Carefully unpack all loose items from shipping carton and make sure all parts are accounted for.

Figure 1 Contents

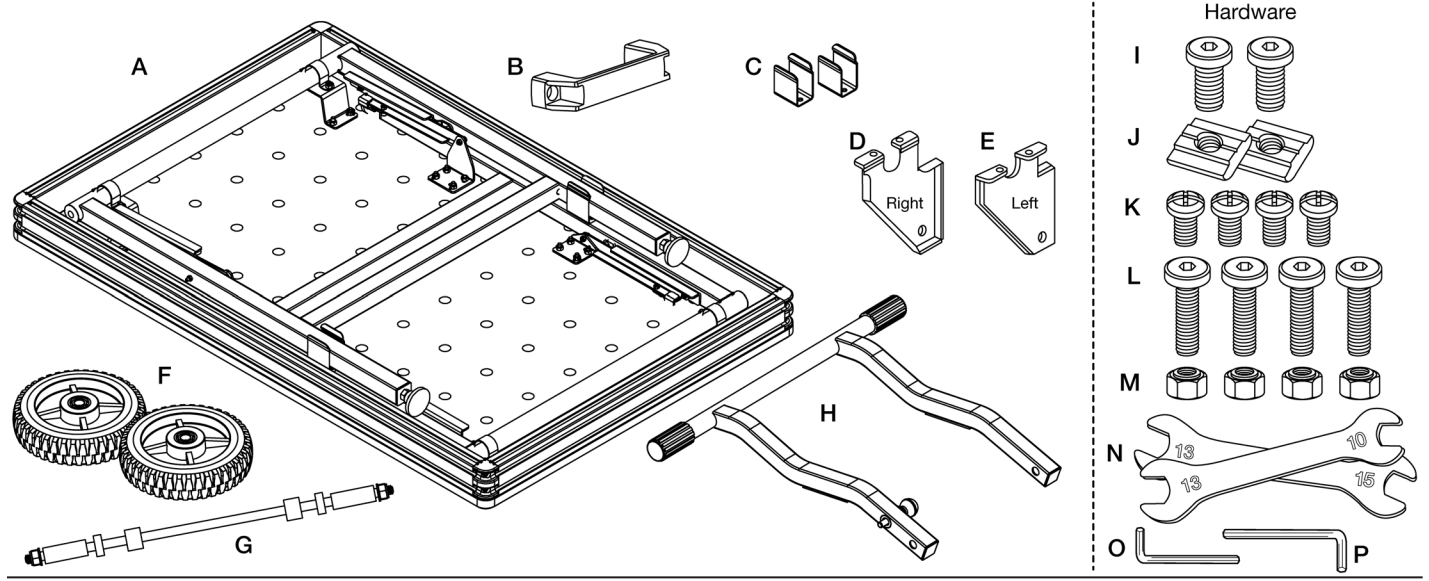

ITEM	DESCRIPTION	QTY	ITEM	DESCRIPTION	QTY
A	Table and Legs (assembled)	1	I	Socket Bolts, M8xP1.25x20L	2
B	Handle	1	J	T-Type Nuts, M8xP1.25	2
C	U-Shaped Locks	2	K	Round Head Phillips Bolts, M6xP1.0x10L	4
D	Right Axle Support Bracket	1	L	Socket Bolts, M6xP1.0x25L	4
E	Left Axle Support Bracket	1	M	Nuts, M6xP1.0	4
F	Wheels	2	N	Open Wrench, 13 mm/10 mm & 13 mm/15 mm	1 ea.
G	Axle and Hardware Set	1	O	Hex Wrench, 4 mm	1
H	Kickstand	1	P	Hex Wrench, 6 mm	1

4 ASSEMBLY

Figure 2



Pinch risk. Be aware of hands and fingers at all times.

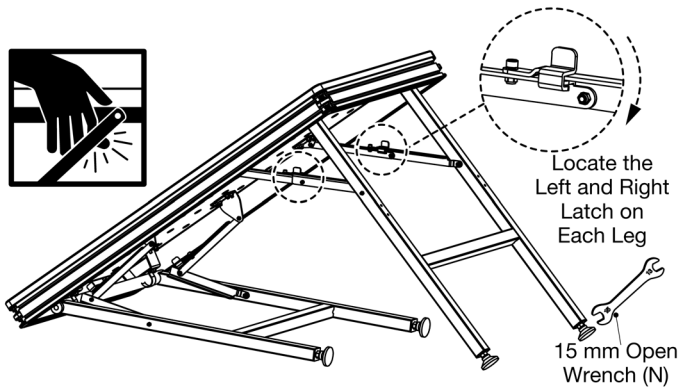

The MT4012 Project Table arrives with legs already assembled. The foot of each leg is equipped with a swivel foot. Adjust the height of each foot using the 15 mm wrench (included).

Figure 3

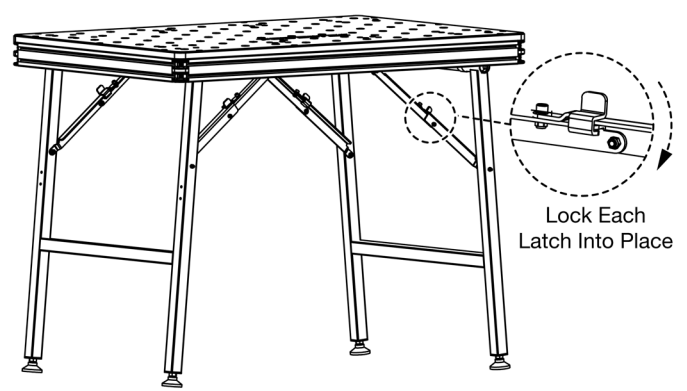

1. Place the Project Table on the floor, face up.
2. Lift one end, grab the horizontal bar on the legs and pull.
3. Push the support bars into place.
4. Lock into place by pushing down on the locking latches.

Figure 4

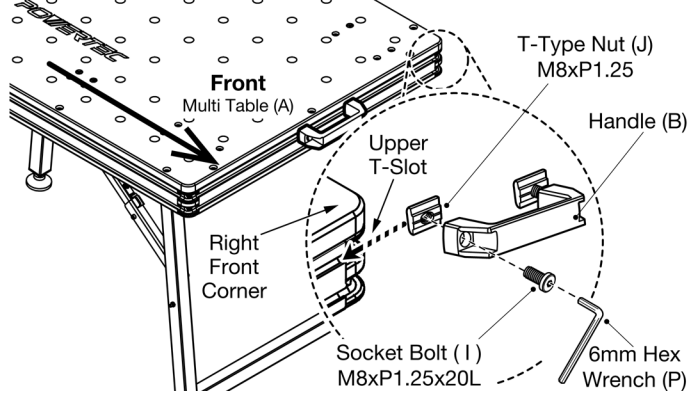

Note the location of the POWERTEC logo—this is the "Front" of Project Table (A). Push two Socket Bolts (I) through the holes in Handle (B) and loosely thread them into the T-Type Nuts (J). Slide the assembly into the upper T-Slot on the right end of Project Table (A). Secure using 6 mm Hex Wrench (P) supplied.

Figure 5

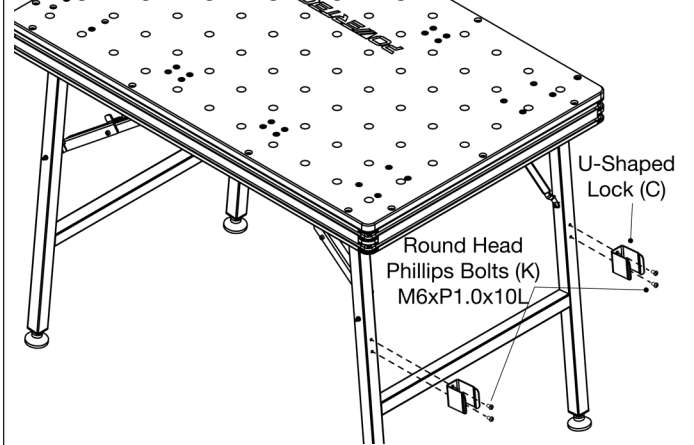

On the "Back" of the Project Table attach the two U-Shaped Locks (C) using 4 Round Head Phillips Bolts (K). Secure into place using a Phillips screw driver (not included).

Figure 6

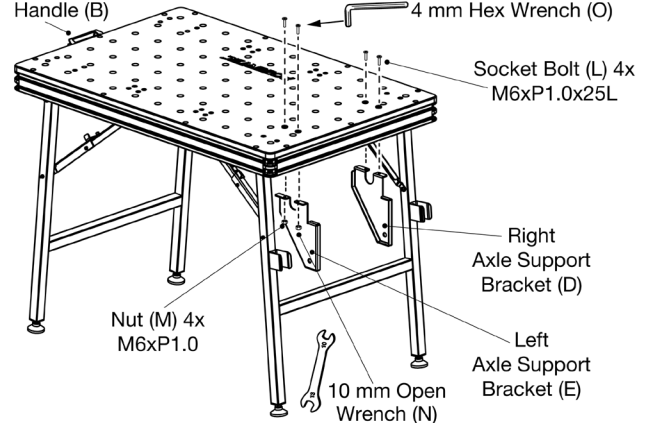

From the "Back"—with Right (D) and Left (E) Axle Supports facing each other, locate the predrilled holes in the Project Table top. Attach with 4 Socket Bolts (L) and 4 Nuts (M). Secure using 4 mm Hex Wrench (O) and 10 mm Open Wrench (N), supplied.

Figure 7

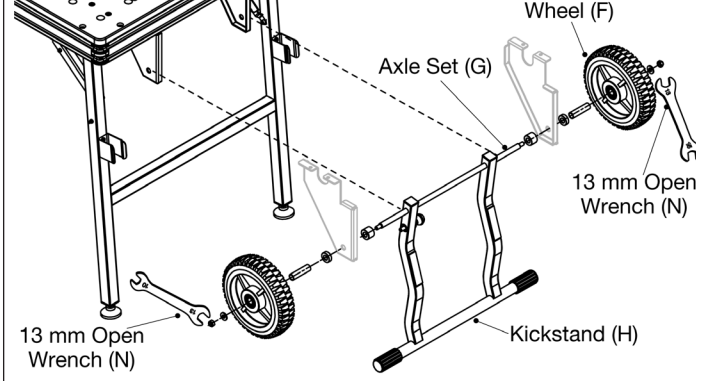

Breakdown Axle Set (G). Insert the Axle Bar through each hole in Right (D) Left (E) Axle Supports. Position Kickstand (H) assembly relative to the axle supports as shown. Slide Wheels (F) onto the axle with the offset wheel bearings toward the axle inside. Thread washer and nut onto axle using the 13 mm Open Wrenches (N) included. Tighten the nuts to a hard stop.

OPERATION

Figure 8

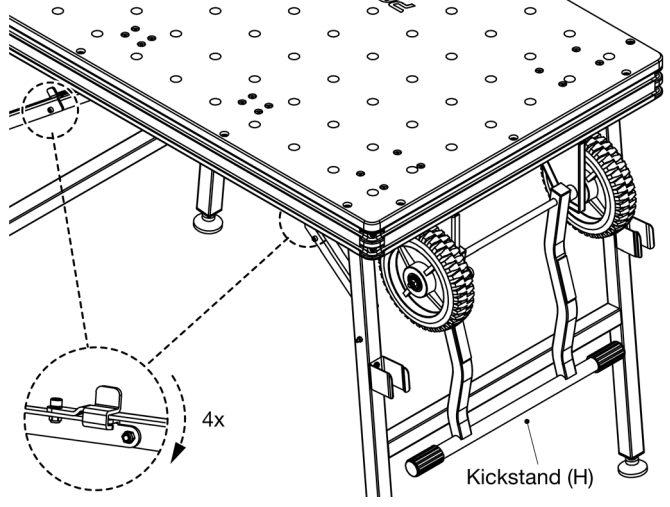

Ensure all underside latches are in place, secured, and locked before using this Project Table.

Figure 9

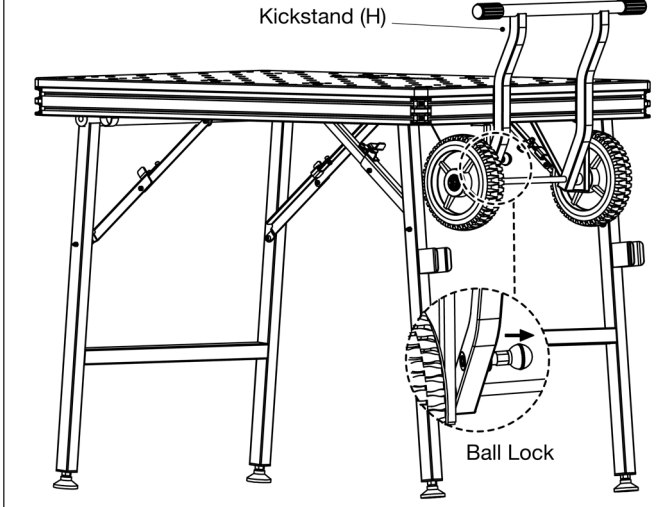

To reposition Kickstand (H) pull the Ball Lock pin out from the left support bar. This allows repositioning of the Kickstand.

Figure 10

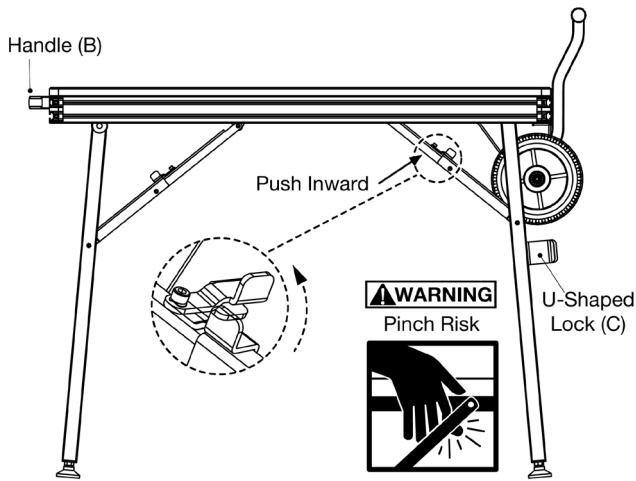

To stow the Project Table—First unlatch the support locks on the side of the Project Table with the Kickstand. It is necessary to store these legs first as the second pair fit into U-Shaped Locks (C).

Figure 11

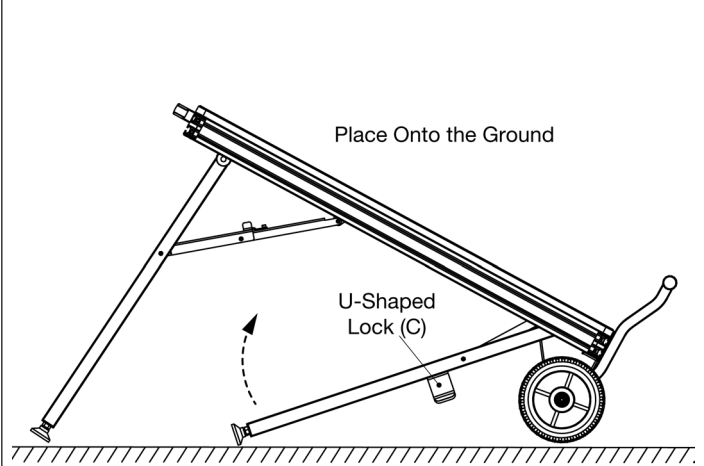

Place the wheels onto the ground and fold these legs into the underside of the table top.

Figure 12

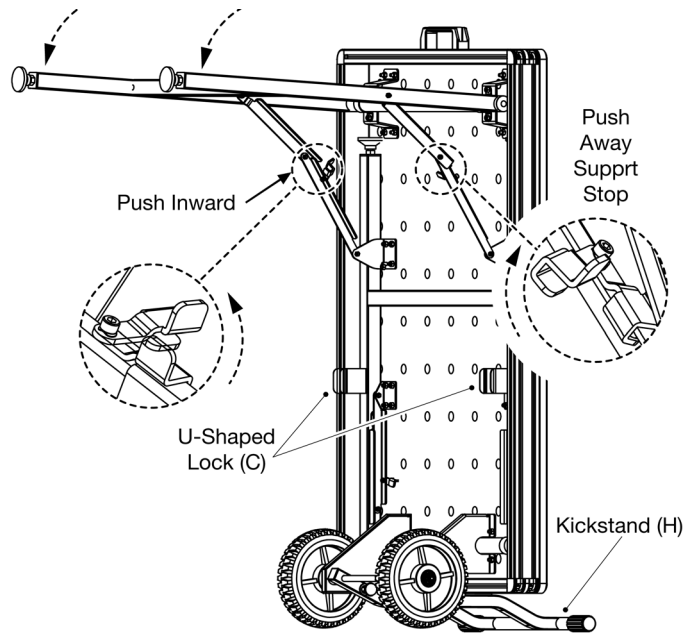

Rest the table upright and onto Kickstand (H). Unlatch the support locks on the second pair of legs and push into the U-Shaped Locks (C) on first pair of legs.

Figure 13

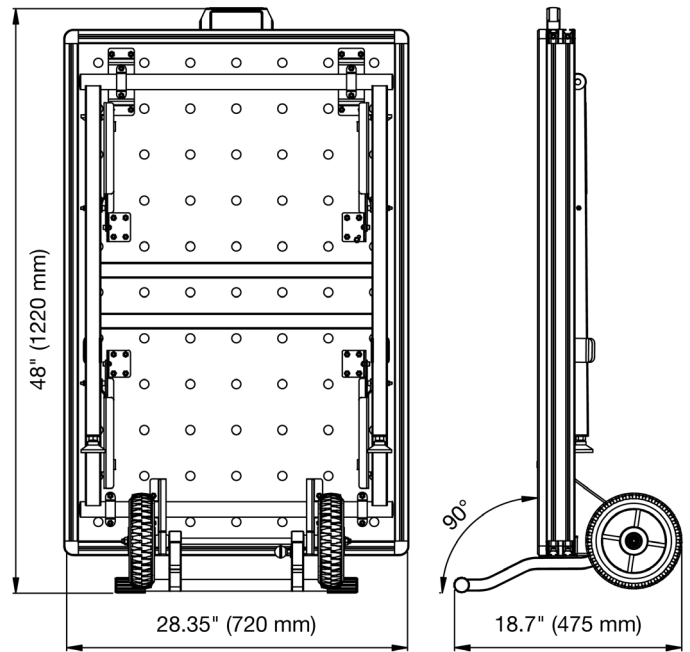

The MT4012 Project Table is now ready for storage.



MAINTENANCE

WARNING

When servicing, use only identical replacement parts. Use of any other parts may create a hazard or cause product damage. To ensure safety and reliability, all repairs should be performed by a qualified service technician.

WARNING

Keep the Project Table dry, clean, and free from oil and grease. Always use a clean cloth when cleaning. Never use brake fluids, gasoline, petroleum-based products or any strong solvent to clean the Project Table. Chemicals can damage, weaken or destroy plastic which may result in serious personal injury.

WARNING

Always use caution when moving the Project Table. Debris on the floor or other irregularities in the path of travel could cause the wheels to stop suddenly and cause the stand to tip on the floor or other irregularities in the path of travel could cause the wheels to stop suddenly and cause the stand to tip.

PROJECT TABLE PARTS LIST AND ILLUSTRATION



Key No.	Part No.	Description	Specification	Qty
1	MT4012001	Table	1100x720x18mm	1
2	MT4012002	Aluminum Extrusion	3060x1090mm	2
3	MT4012003	Aluminum Extrusion	3060x660mm	2
4	MT4012004	End Cap		4
5	MT4012005	R Bracket		1
6	MT4012006	L Bracket		1
7	MT4012007	Foot Pad	M10xP1.5	4
8	MT4012008	R Axle Support Bracket		1
9	MT4012009	L Axle Support Bracket		1
10	MT4012010	Wheel	Φ206x42mm	2
11	MT4012011	Kickstand		1
12	MT4012012	Axle Set	Φ12x446Lmm	1
13	MT4012013	Spacer	Φ12.1xΦ25x18.2mm	2
14	MT4012014	Spacer	12.1x25x8mm	2
15	MT4012015	Rubber	80x21x3mm	2
16	MT4012016	Support-up		4
17	MT4012017	Support-down		4
18	MT4012018	U-shaped Lock		2
19	MT4012019	Support-stop		4
20	MT4012020	End plug	Φ31.8	4
21	MT4012021	End plug	Φ25.4	2
22	MT4012022	Pipe Plug Nut	M10xP1.5	4

Key No.	Part No.	Description	Specification	Qty
23	MT4012023	Handle		1
24	MT4012024	Short Support Plate		2
25	MT4012025	Long Support Plate		2
26	MT4012026	Support		2
27	MT4012027	Pipe Clamp	Φ31.8	4
28	MT4012028	Socket Bolt	M6XP1.0x25L	32
29	MT4012029	T type Nut	M8xP1.25	16
30	MT4012030	Hex Socket Bolt	M6xP1.0x25L	8
31	MT4012031	Hex Socket Bolt	M5xP0.8x45L	4
32	MT4012032	Hex Socket Bolt	M5xP0.8x12L	12
33	MT4012033	Round Head Phillips Bolts	M6xP1.0x10L	4
34	MT4012034	Washer	Φ8.2xΦ19x2	2
35	MT4012035	Socket	M12	1
36	MT4012036	Ball Lock	M12	1
37	MT4012037	Square End Plug	Φ25.4	2
38	MT4012038	Hex Head Bolt	M6xP1.0x12L	4
39	MT4012039	Socket Bolt	M8XP1.25x20L	16
40	MT4012040	Wave Washer	M42	4
41	MT4012041	Nut	M8xP1.25	2
42	MT4012042	Nut	M6xP1.0	32
43	MT4012043	Nut	M5xP0.8	16
44	MT4012044	Axle Bushing	Φ15XΦ12X55L	2

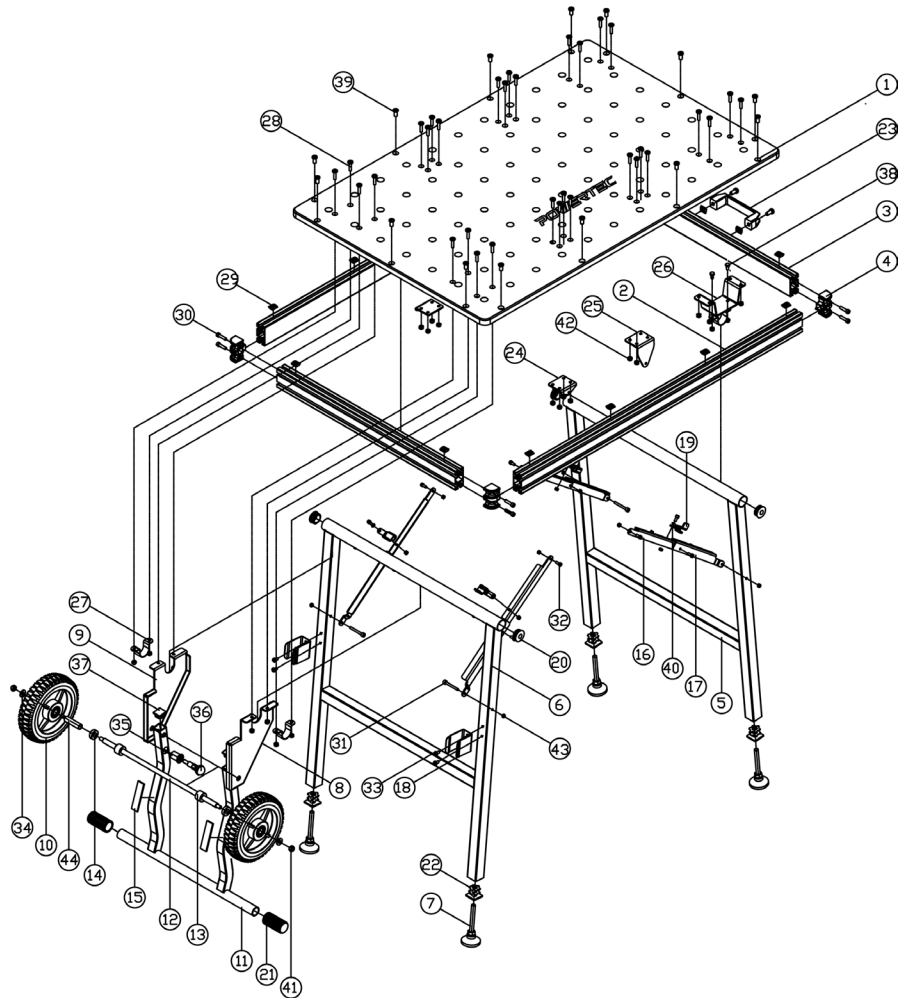

WARRANTY

Thank you for investing in a **POWERTEC** power tool. This product has been designed and manufactured to meet high quality standards and is guaranteed for domestic use against defects in workmanship or material for a period of 12 months from the date of purchase. This guarantee does not affect your statutory rights.

SOUTHERN TECHNOLOGIES LLC. BENCH TOP AND STATIONARY POWER TOOL LIMITED 1 YEAR WARRANTY AND 30-DAY SATISFACTION GUARANTEE POLICY

POWERTEC products are designed and manufactured by **Southern Technologies LLC**. All warranty communications should be directed to **Southern Technologies LLC** by calling 847-780-6120 (toll free), 9 AM to 5 PM, Monday through Friday, US Pacific Time.

30- DAY SATISFACTION GUARANTEE POLICY

During the first 30 days after the date of purchase, if you are dissatisfied with the performance of this **POWERTEC** tool for any reason, you may return the tool to the retailer from which it was purchased for a full refund or exchange. You must present proof of purchase and return all original equipment packaged with the original product. The replacement tool will be covered by the limited warranty for the balance of the one year warranty period.

LIMITED ONE YEAR WARRANTY

This warranty covers all defects in workmanship or materials in this **POWERTEC** tool for a one year period from the date of purchase. This warranty is specific to this tool. **Southern Technologies, LLC** reserves the right to repair or replace the defective tool, at its discretion.

HOW TO OBTAIN SERVICE

To obtain service for this **POWERTEC** tool you must return it, freight prepaid, to **POWERTEC**. You may call (toll free) 847-780-6120 for more information. When requesting warranty service, you must present the proof of purchase documentation, which includes a date of purchase. **POWERTEC** will either repair or replace any defective part, at our option at no charge to you. The repaired or replacement unit will be covered by the same limited warranty for the balance of one year warranty period.

WHAT IS NOT COVERED

This warranty applies to the original purchaser at retailer and may not be transferred.

This warranty does not cover consumable items such as saw blades, knives, belts, discs, cooling blocks, and sleeves. This warranty does not cover required service and part replacement resulting from normal wear and tear, including accessory wear.

This warranty does not cover any malfunction, failure or defect resulting from:

- 1) Misuse, abuse, neglect and mishandling not in accordance with the owner's manual.
- 2) Damage due to accidents, natural disasters, power outage, or power overload.
- 3) Commercial or rental use.
- 4) Alteration, modification or repair performed by persons not recommended by **POWERTEC**.

DISCLAIMER

To the extent permitted by applicable law, all implied warranties, including warranties of MERCHANTABILITY or FITNESS FOR A PARTICULAR PURPOSE, are disclaimed. Any implied warranties, that cannot be disclaimed under state law are limited to one year from the date of purchase. **Southern Technologies LLC** is not responsible for direct, indirect, incidental or consequential damages. Some states do not allow limitations on how long an implied warranty lasts and/or do not allow the exclusion or limitation of incidental or consequential damages, so the above limitations may not apply to you. This warranty gives you specific legal rights, and you may also have other rights which vary from state to state. Southern Technologies LLC., makes no warranties, representations, or promises as to the quality or performance of its power tools other than those specifically stated in this warranty.

POWERTEC[®]

Southern Technologies LLC • Chicago • IL 60606