



35mm Concealed Hinge Jig



WARNING

Do not use the 35mm Concealed Hinge Jig until you have read and understood all the operating instructions and the operating manual of the drill being used with this Hinge Jig.

WARNING

To avoid serious injury, turn off and unplug the machine before attaching or changing accessories or adjusting the router bit.

WARNING

BEFORE beginning any cutting operation, **ALWAYS** make sure **ALL** parts of the 35mm Concealed Hinge Jig are assembled correctly before operation.

DANGER

Risk of serious injury. The Hinge Bit is extremely sharp. Always wear proper gloves when handling the Hinge Bit. Keep hands and fingers away from spinning router bits. Be aware of the cutting apparatus at all times.

WARNING

When using the 35mm Concealed Hinge Jig do not drill through any metal material.

CAUTION

Think safety! Safety is a combination of operator common sense and alertness at all times when a tool is being used.

PACKAGING CONTENTS

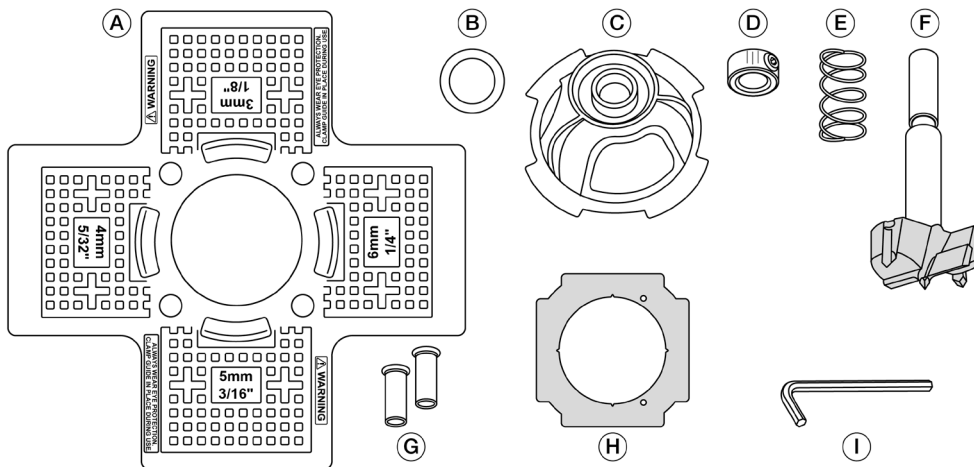

| ITEM | DESCRIPTION | QTY |
|------|---------------------|-----|
| A | Base Guide | 1 |
| B | Bearing Washer | 1 |
| C | Drill Guide | 1 |
| D | Stop Collar | 1 |
| E | Spring | 1 |
| F | 35mm Forstner Bit | 1 |
| G | Set Pins | 2 |
| H | Pilot Hole Template | 1 |
| I | Hex Wrench | 1 |

Bit Assembly:

Figure 2

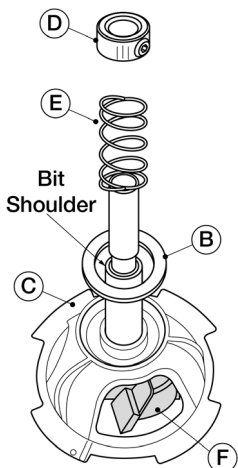

1. First remove Drill Guide (C) by turning it counterclockwise to remove it from Base (A). Remove Pins (G) by pushing them out from the bottom.
2. To assemble, slide the shaft of Concealed Hinge Bit (F) through the opening in the bottom of Drill Guide (C).
3. Slide Bearing Washer (B) over the shaft of the Concealed Hinge Bit and seat it into the inset on top of the Drill Guide.
4. Place Spring (E) over the Hinge Bit shaft.
5. Seat Stop Collar (D) on the shaft shoulder. Tighten with Hex Wrench (I) conveniently stored beneath the base.

WARNING

To avoid serious injury wear gloves when handling the drill bit. It is extremely sharp.

NOTE: This is a custom 35mm Concealed Hinge Bit. The shoulder length accurately positions the Stop Collar and is designed to drill a pocket 1/2" deep.

Measure for Concealed Hinge Jig Placement:

1. Prepare a clean work area to avoid scuffing the cabinet doors.
2. Place the cabinet door face down on the surface with the hinge side facing toward you.
3. To determine the spacing required for the hinge distance from the door edge to the 35mm hinge cup pocket consult the instructions included with the hinges or by visiting the manufacturer's website. Some hinge instructions include templates with no dimensions given. To determine the offset, measure the template from the edge of the door line to the edge of the 35mm hinge cup pocket.
4. See Figure 3. Measure and mark the distance from the top then the bottom edge using a ruler, tape measure, or combination square. Once top hinge center is determined mark a horizontal line with a pencil. Then measure the same distance from the bottom edge of the door and mark a line.

Figure 3

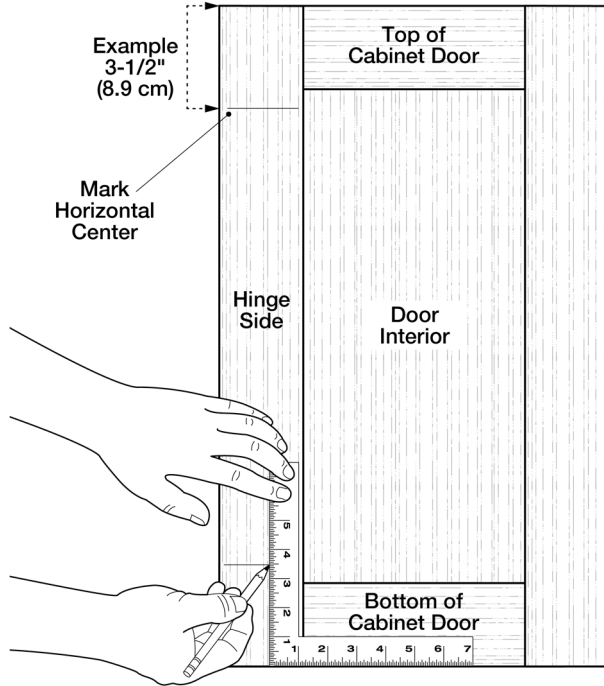

5. See Figure 4. The offset measurements will be one of four options and indicated in inches or millimeters: 3mm-1/8" • 4mm-5/32" • 5mm-3/16" • 6mm-1/4".
6. For this example 5mm-3/16" will be used. Place the magnetic Pilot Hole Template (H) on the underside of the Base with the pilot holes facing opposite the 5mm-3/16" wing of the Base.
7. Place Set Pins (G) in each hole above the selected size.
8. Align the horizontal Center Notches on the Pilot Hole Template to the markings on the cabinet door.

Figure 4

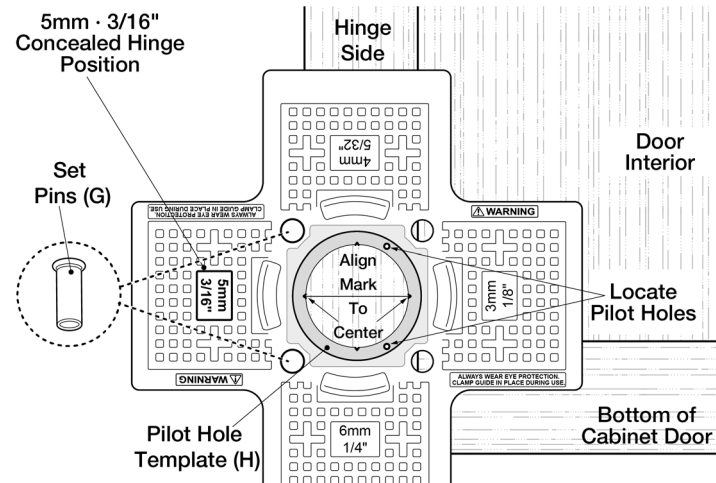

Cut the Hinge Pockets:

1. See Figure 5. Use two non-marring clamps on both sides of the 5mm-3/16" setup securing the Concealed Hinge Jig in place.
2. Drill two 1/16" pilot holes using the Pilot Hole Template.

Figure 5

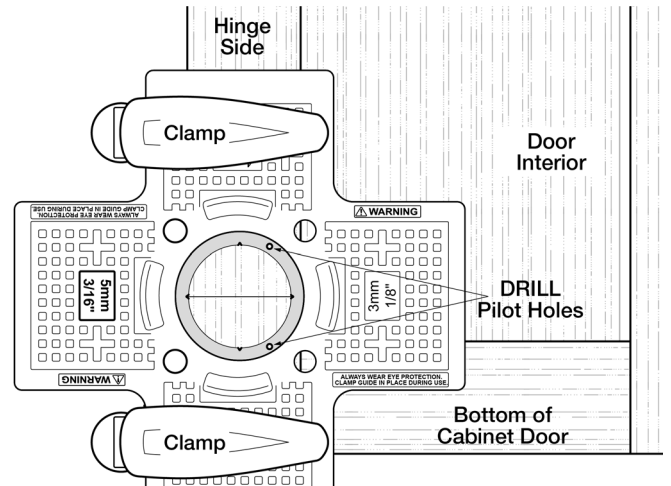

3. See Figure 6. Attach the Concealed Hinge Bit Assembly to a power drill using a 3/8" chuck.
4. Set the Drill Guide Assembly onto Base (A) as shown. Lock into place by turning the Drill Guide clockwise until all four Drill Guide tabs are locked into place on the Base.
5. Engage the drill to full speed before drilling into the wood. Drill until Stop Collar (D) makes contact with the Drill Guide.

Figure 6

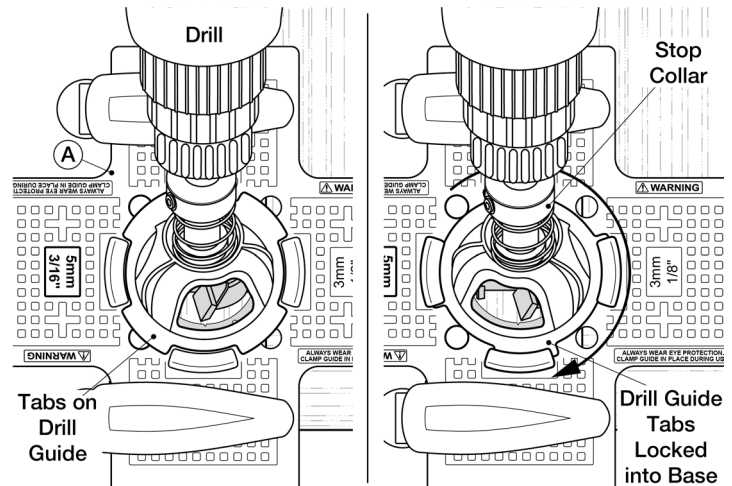

6. See Figure 7. Remove the Concealed Hinge Guide Assembly from the Base by turning counterclockwise, revealing a perfect hinge cup pocket.

Figure 7

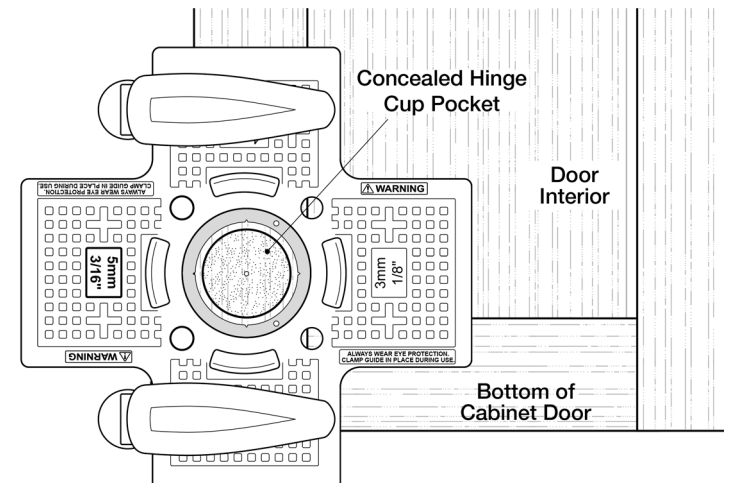

Install the Concealed Hinge (not included)

7. Follow the hinge manufacturer's instructions for installing and positioning the hinge-mounting plates into the cabinet.

Figure 8

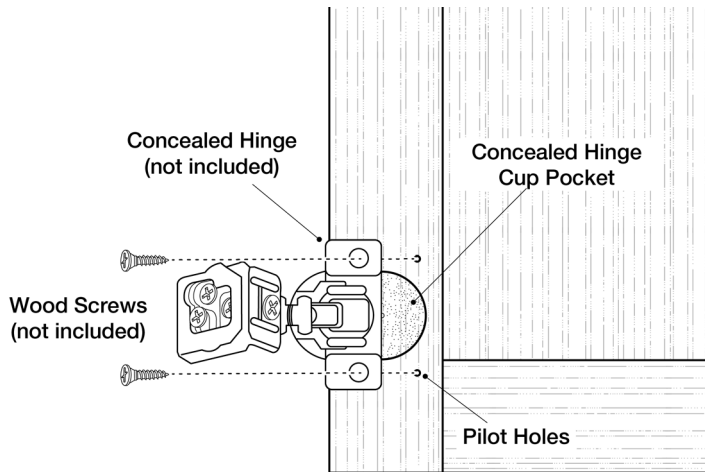

GENERAL MAINTENANCE

⚠ WARNING

When servicing, use only identical replacement parts. Use of any other parts may create a hazard or cause product damage. To ensure safety and reliability, all repairs should be performed by a qualified service technician.

⚠ WARNING

Keep the Concealed Hinge Jig dry, clean, and free from oil and grease. Always use a clean cloth when cleaning. Never use brake fluids, gasoline, petroleum based products or any strong solvent to clean the Concealed Hinge Jig. Chemicals can damage, weaken or destroy plastic which may result in serious personal injury.

POWERTEC[®]

Visit us on the web at www.powertecproducts.com



Put these instructions and the original sales invoice
in a safe, dry place for future reference.

Southern Technologies, LLC • Chicago, IL 60606