



Deep Switch Box with Hardware for POWERTEC Switch Compatibility -

71007

71008

71651

71652

71054

71577



Connect Ground Wires Before Using Power Tools.

Please follow the wiring diagram of the switch used with this switch box. Use proper connectors for wiring.

The included nylon spacers will be required to provide proper fit for POWERTEC 71007, 71008, 71651, and 71652 switches.

When installing POWERTEC Switch - 71007, 71008, 71651 or 71652 (sold separately) into the 71834 Deep Switch Box:

1. Remove the original screws from the switch. Attach the switch with the Cross Recessed Tapping Screws and Nylon Spacers (included).
2. Attach the 2 Cable Glands (included) to the bottom of the 71834 Deep Switch Box.

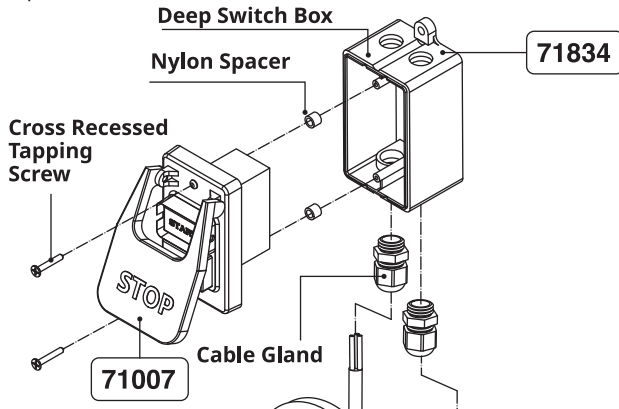

When installing POWERTEC Switch - 71054 or 71577 (sold separately) into the 71834 Deep Switch Box:

1. Remove the original screws from the switch. Attach the switch with the Cross Recessed Tapping Screws (included).
2. Attach the 2 Cable Glands (included) to the bottom of the 71834 Deep Switch Box.

