

DuBois®

Drill Press Fence Set



SAFETY RULES

⚠ WARNING

For your own safety, read all of the rules and precautions before operating tool.

⚠ WARNING

Always follow proper operating procedures as defined in this manual even if you are familiar with use of this Drill Press Fence Set or any tool used with this Drill Press Fence Set. Remember that being careless for even a fraction of a second can result in severe personal injury.

Before using another tool with this product, always read, understand and follow the instructions and safety warnings in the owner's manual for that tool. If you do not have the owner's manual, obtain one from the tool's manufacturer before using it with this product.

You must be familiar with the use of any tool or accessory used with this Drill Press Fence Set. The supplier cannot be held responsible for any accident, injury or damage incurred while using this Drill Press Fence Set with any tool.

It is the responsibility of the purchaser of this product to ensure that any person using this product reads and complies with all instructions and safety precautions outlined in this manual and the operating manual of the tool being used prior to use.

Some dust created by operation of power tools can expose you to chemicals known to the State of California to cause cancer, birth defects or other reproductive harm. To reduce your exposure to these chemicals, work in a well ventilated area and work with approved safety equipment. Always wear OSHA/NIOSH approved, properly fitting face mask or respirator when using such tools.

⚠ CAUTION

Do not modify or use this Drill Press Fence Set for any application other than that for which it was designed.

FOLLOW ALL STANDARD SHOP SAFETY PRECAUTIONS, INCLUDING:

- Keep children and visitors at a safe distance from work area.
- Keep work area clean. Cluttered work areas invite accidents. Work area should be properly lit.
- Do not use power tools in dangerous environments. Do not use power tools in damp or wet locations. Do not expose power tools to rain.
- TURN OFF AND UNPLUG all power tools BEFORE making any adjustments or changing accessories.
- Be alert and think clearly. Never operate power tools when tired, intoxicated or when taking medications that cause drowsiness.
- Wear proper apparel. Do not wear loose clothing, gloves, neckties, rings, bracelets or other jewelry which may get caught in moving parts of the tool.
- Wear protective hair covering to contain long hair.
- Wear safety shoes with non-slip soles.
- Wear safety glasses complying with United States ANSI Z87.1. Everyday glasses have only impact resistant lenses. They are NOT safety glasses.
- Wear face mask or dust mask if operation is dusty.
- A guard or any other part that is damaged should be properly repaired or replaced. Do not perform makeshift repairs.
- Use safety equipment such as featherboards, push sticks and push blocks, etc., when appropriate.
- Maintain proper footing at all times and do not overreach.
- Do not force woodworking tools.

⚠ CAUTION

Think safety! Safety is a combination of operator common sense and alertness at all times when tool is being used.

⚠ CAUTION

Do not use the Drill Press Fence Set until it is completely assembled and you have read and understood this entire operating manual and the operating manual of the tool being used with this Drill Press Fence Set.

**SAVE ALL WARNINGS AND INSTRUCTIONS
FOR FUTURE REFERENCE**

PACKAGING CONTENTS

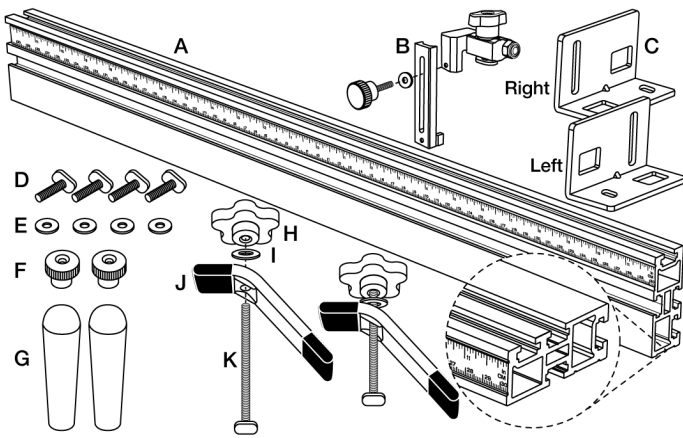

ITEM	DESCRIPTION	QTY
A	Fence, 24" x 1" x 2-1/2"	1
B	Flip stop assembly, 1" to 3-1/2"	1
C	Mounting Brackets, 1-5/16"x1-13/16"x.116" (right and left)	2
D	T-bolts, 1/4"-20, 1" Long	4
E	Washers, 1/4"	4
F	Round knobs, 1/4"-20, 1" diameter	2
G	Handles, 1/4"-20, 3-7/8" Long	2
H	5/16"-18 Five Star Knobs	2
I	5/16" Washers	2
J	5-1/2" Hold Down Clamps	2
K	5/16"-18 x 3-1/2" T-Bolts	2

ASSEMBLY

High Profile Set-Up

- NOTE: Right or Left configuration.** Loosely assemble mounting bracket (C), short side down. Insert T-bolt (D) through hole on the bottom of bracket and place Washer (E) and Handle (G) on the T-bolt. Loosely assemble T-bolt (D), Washer (E) and Round Knob (F) into bracket slot. Figure 1
- Slide the T-bolt attached to the handle into table slot.
- Vertically position** fence with single T-slot on top, ruler to front, double slots to the back. Slide fence toward loosened T-bolt (with knob) and maneuver T-bolt into the upper slot. Secure by tightening knob. Figure 2 (shown right side setup)
- The fence is equipped with a zero-center scale. Using a drill bit or laser, slide fence to set zero point. Figure 3
- Adjust fence to your application and tighten all knobs.

Figure 1

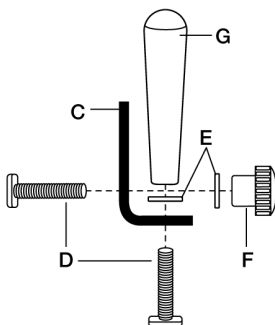

Figure 2

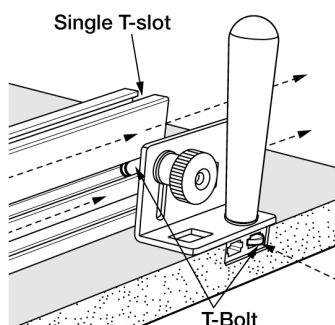
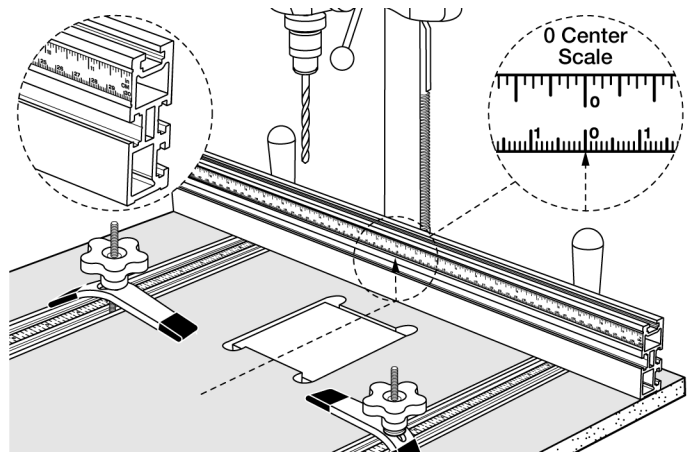

Figure 3



Low Profile Set-up

- Assemble the mounting bracket. Figure 1
- Slide the T-bolt attached to the handle into table slot.
- Horizontally position** fence with double T-slots on top, ruler to front, single slot to the back. Slide fence toward loosened T-bolt (with knob) and maneuver T-bolt into the single slot. Secure by tightening knob. Figure 4 (shown right side setup)
- The fence is equipped with a zero-center scale. Using a drill bit or laser, slide fence to set zero point. Figure 5
- Adjust fence to your application and tighten all knobs.

Figure 4

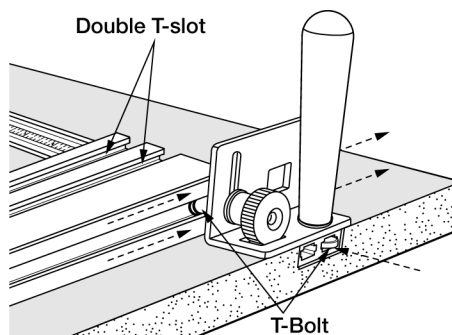
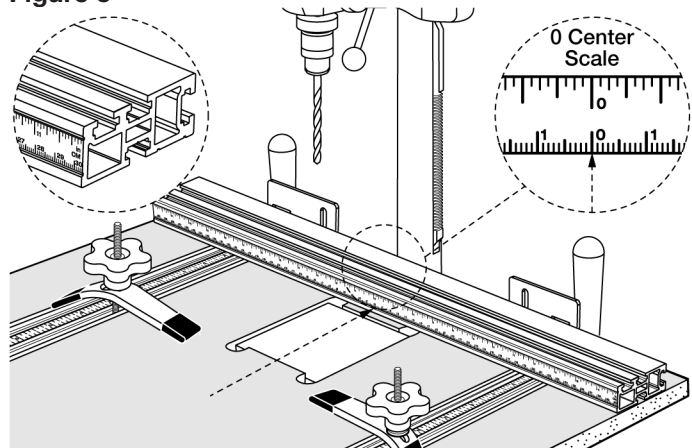

Figure 5



NOTE: After each set-up, verify that the drill chuck and bit are clear of the fence and stop. Contact from either could damage the fence and cause the operator potential harm.

Assemble and Adjust the Height of Flip Arm

Loosen the stud knob. Slide the flip arm to the position to match your height requirement, and then tighten the knob. Make sure the washer is between the flip arm and stud knob. The height of the flip arm can be adjusted from 1" to 3-1/2". Figure 6

Figure 6

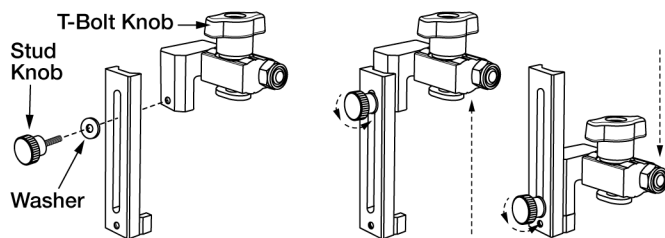

To Convert from Inboard to Outboard Position

Remove the wing knob and T-Bolt and rotate the stop body 180°. Replace the wing knob and T-bolt. Figure 7

Figure 7

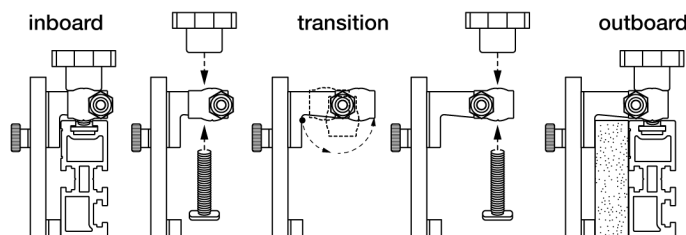

This Adjustable Flip Stop is extremely versatile and quickly converts from INBOARD to OUTBOARD position for a variety of applications. The wedge design reduces any slop or side movement. In addition, the flip arm can be easily moved from right to left to match your feed direction requirements.

Loosen the T-bolt knob and slide the flip stop into the top T-Slot of the fence. The flip stop is multi-functional and can be adjusted for several different applications. Figures 8 and 9

Figure 8

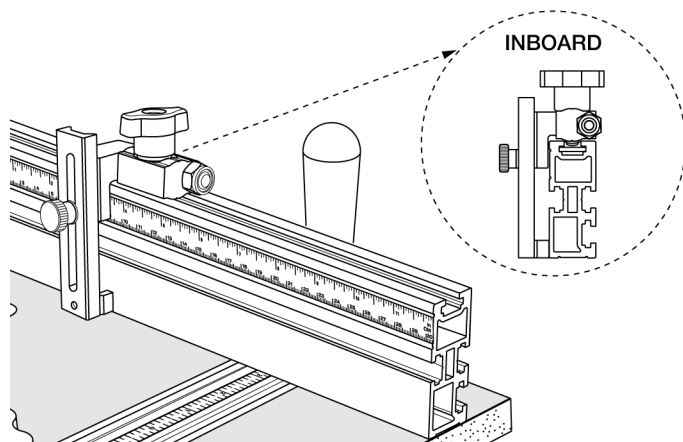

In the INBOARD position, the stop works with single wide multi track fences and functions as an easily adjustable stop.

Figure 9

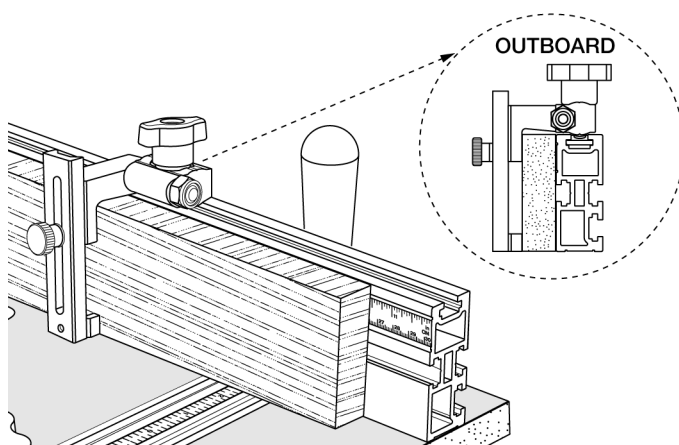

In the OUTBOARD position, the body rotates and the flip arm moves out. In this position the stop can work with multi track fences and sacrificial wood boards.

NOTE: For OUTBOARD settings:
Maximum material thickness 23/32"
Maximum material height 2-1/2"

To Move the Flip Arm

Remove the lock nut and reposition the flip arm assembly to the required side of the body. Make sure nylon washer is between the flip arm and body and replace lock nut. Figure 10

Figure 10

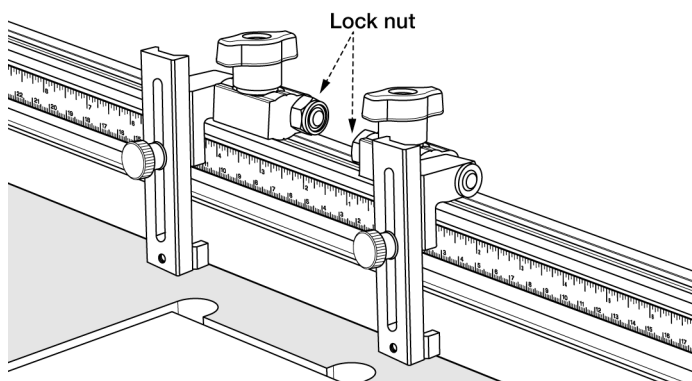

To Assemble and Use Hold Down Clamps

Figure 11

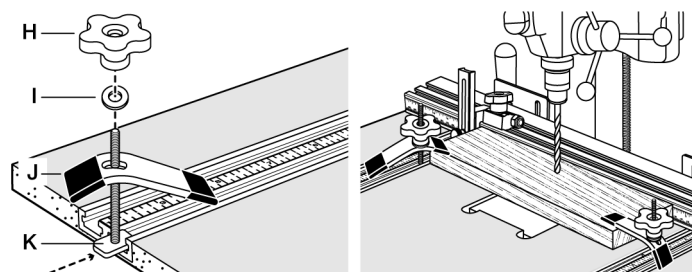

1. Loosen knob on hold down clamp.
2. Slide clamp along table slot to desired point. Position clamp onto workpiece.
3. Tighten knob to secure clamp and workpiece in place.

GENERAL MAINTENANCE

WARNING

When servicing, use only identical replacement parts. Use of any other parts may create a hazard or cause product damage. To ensure safety and reliability, all repairs should be performed by a qualified service technician.

WARNING

Keep the Drill Press Fence Set dry, clean, and free from oil and grease. Always use a clean cloth when cleaning. Never use brake fluids, gasoline, petroleum based products or any strong solvent to clean the drill press fence set. Chemicals can damage, weaken or destroy plastic which may result in serious personal injury.

DuBois[®]

Visit us on the web at www.powertecproducts.com



Put these instructions and the original sales invoice in a safe, dry place for future reference.

Southern Technologies, LLC
Chicago, IL 60606