

**POWERTEC®**

# 13" Flooring Cutter

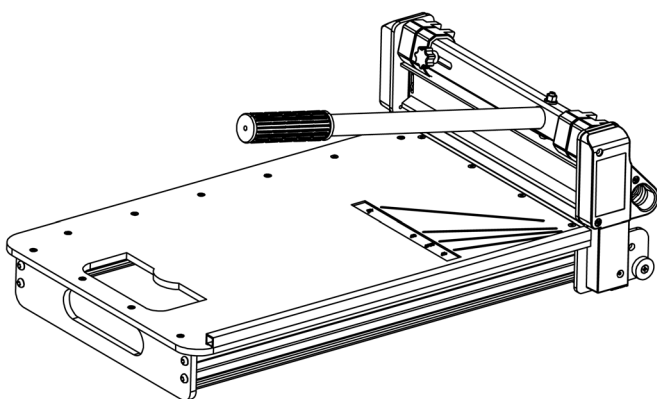

## SPECIFICATIONS

Dimensions..... 25.07" x 15.65" x 14"  
.....(637 x 397.6 x 356mm)  
Weight..... 15 lbs (6.8kg)  
Blade Material ..... HSS  
Blade Size..... 13.39" x 1.1" x 0.087"  
.....(340 x 28 x 2.2mm)  
Angle Marking ..... 15°, 22.5°, 30°, 45°  
Max Cutting Width..... 13" (330.2mm)  
Max Material Thickness..... .47" (12mm)

## DIMENSIONS

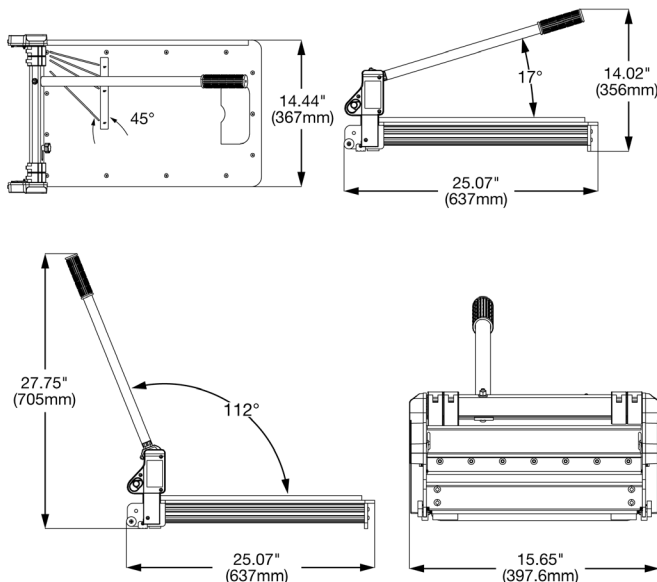

## ⚠ WARNING

For your own safety, read the instruction manual before using the Flooring Cutter.

- **The blade is sharp.** Always keep hands clear while operating the Flooring Cutter or making adjustments.
- Stay alert. Never operate Flooring Cutter when tired, intoxicated or when taking medications that cause drowsiness.
- Wear proper apparel. Wear safety glasses complying with United States ANSI Z87.1.
- Use the Flooring Cutter on a firm and flat surface.
- Do not force the Flooring Cutter to do a job for which it was not designed.
- Keep children and visitors at a safe distance from work area.
- Keep the work area clean and well lit.

**SAVE ALL WARNINGS AND INSTRUCTIONS FOR FUTURE REFERENCE**

## UNPACKING CONTENTS

**NOTE:** Check for shipping damage. Check immediately whether all parts and accessories are included.

ITEM	DESCRIPTION	QTY
A	Cutter Head	1
B	Handle	1
C	Base	1
HARDWARE		
4	Hex Socket Bolt M6x50 (for Handle)	1
5	Bolt Support Pad	1
6	Flat Washer	1
7	M6 Hex Nut	1
8	Hex Socket Screws M6x25 (for Cutter Head, 1 spare screw included)	5
9	Hex Wrench 2.5mm & 4mm	1 ea.
10	Open Wrench 10mm	1
11	Honing Stone	1

Figure 1      Some Assembly Required

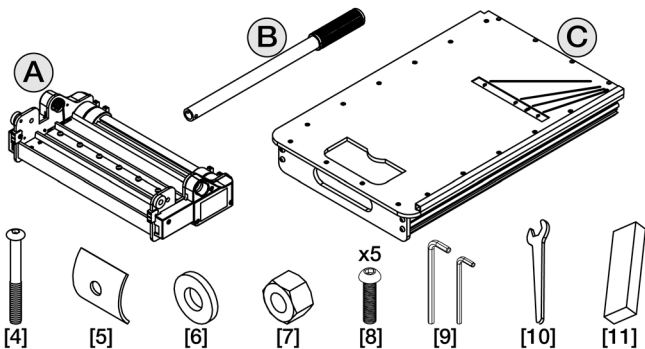

## ASSEMBLY

- Attach Cutter Head (A) to Base (C) with 4pcs M6 Screws [8], using 4mm Hex Wrench [9] included.

Figure 2

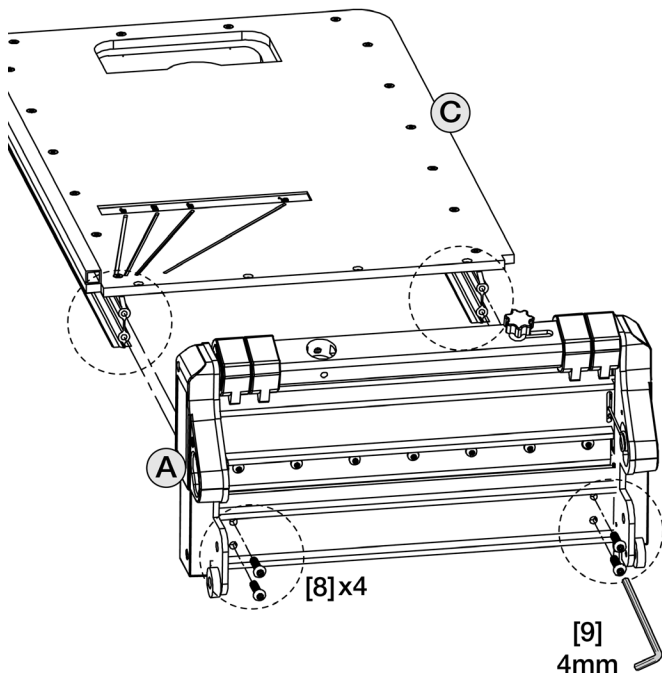

- From the top of Cutter Head (A), insert Handle (B) into hole.
- Slide M6 Hex Bolt M6 x 50 [4] through holes of Bolt Support Pad [5], Cutter Head and Handle.
- Fasten with Flat Washer [6] and M6 Hex Nut [7],
- Tighten using 4mm Hex Wrench [9] and Open Wrench [10].

Figure 3

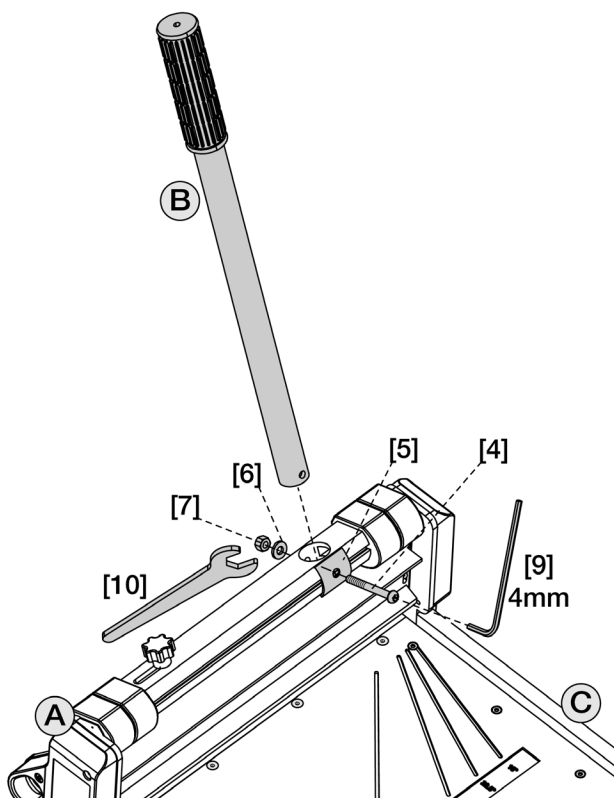

## OPERATION

### 13" Flooring Cutter FEATURES

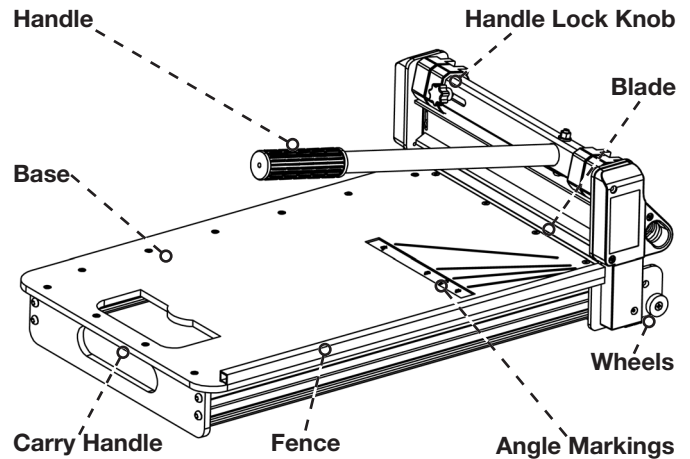

### ⚠ WARNING

Risk of injury. Maintain control on the Handle. Do not allow the Handle to rebound back after making a cut.

### To Unlock and Lock Handle:

- While firmly grasping the Handle, twist Lock Knob counterclockwise to disengage. Do not remove Lock Knob.
- Slide Knob to the right to Unlock—twist clockwise to lock in place.

Figure 4

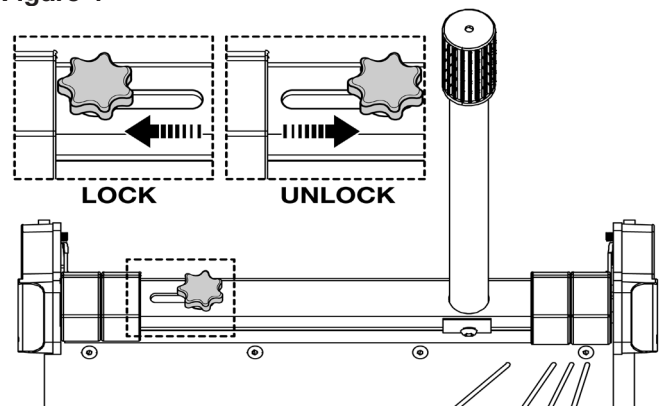

### SUITABLE MATERIALS

Material type
PVC
LVT
LVP
VCT
WPC
SPC
Vinyl Flooring
Laminate Flooring
Engineered Wood Flooring
Rubber Tile

**Note:** Not suitable for Solid Wood Flooring.

## STRAIGHT CUT

- Firmly grasp Handle and on top of Cutter Head (A) rotate Cutter Head Knob counterclockwise, slide Knob to the right to unlock.
- Raise Handle to allow material to pass through.
- Place material against the Fence on the Base.
- Push material forward to desired cut length.
- Press Handle downward to cut.

Figure 5

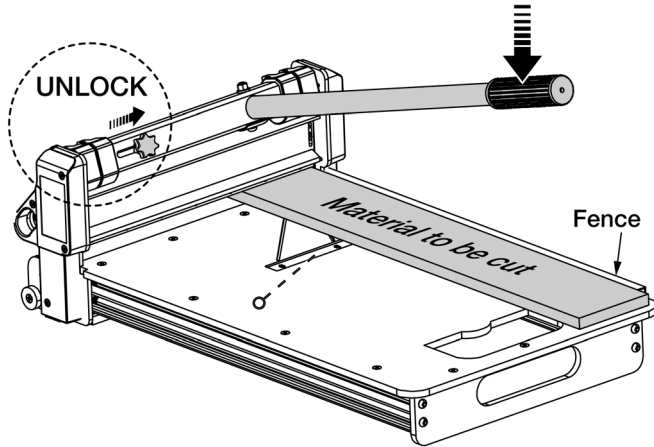

## ANGLE CUT

**NOTE:** The base is engraved with 4 angle markings: 15°, 22.5°, 30°, 45°.

Figure 6

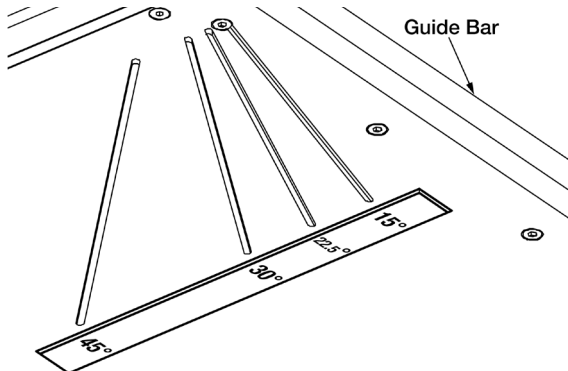

- Firmly grasp Handle and on top of Cutter Head (A) rotate Cutter Head Knob counterclockwise, slide Knob to the right to unlock.
- Raise Handle to allow material to pass through.
- Place material on Base and align to desired angle marking.
- Push material forward to desired cut length.
- Press Handle downward to cut.

Figure 7

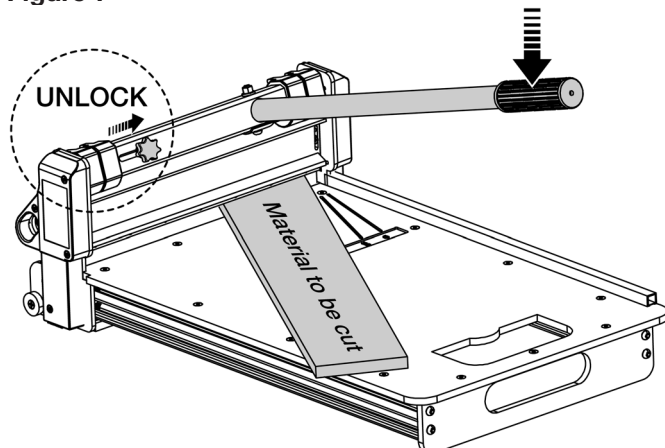

## Carrying or Moving Flooring Cutter: (15 lbs.)

**NOTE:** The FC1300 Flooring Cutter is equipped with a Carry Handle and 2 small wheels.

### To Carry the Flooring Cutter:

- While pressing Handle down, move Cutter Head Knob to the left, away from Handle until mechanism engages the catch, this ensures the Handle will stay down when Handle is released.
- Rotate Cutter Head Knob clockwise to lock.
- Use Carry Handle to pick up and carry or roll with wheels on the ground if needed.

### WARNING

Always secure Cutting Handle with the Lock Knob when not in use or when transporting.

Figure 8

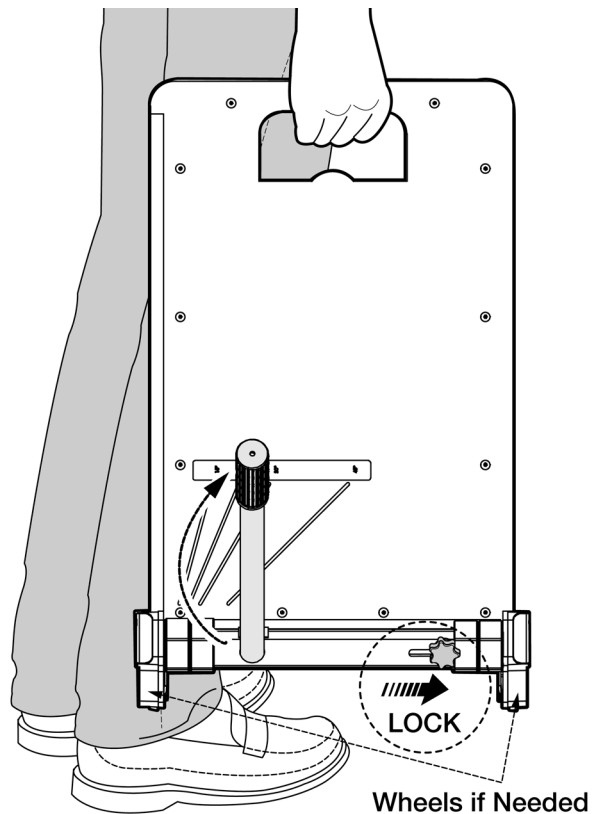

## MAINTENANCE

### To Hone the Blade:

#### **WARNING**

Risk of personal injury. Wear gloves and keep hands clear of the cutting edge when handling or replacing the blade.

To remove burrs from the flat edge of the blade, honing should be done after every 50 to 100 cuts depending on the material being used.

(1<sup>st</sup>) Move Lock Knob toward Handle to unlock.

(2<sup>nd</sup>) Raise Handle.

(3<sup>rd</sup>) Lay flat the included Honing Stone [11] against the flat side of the blade. Move Honing Stone from one end to the other several times until burrs have been removed.

Figure 9

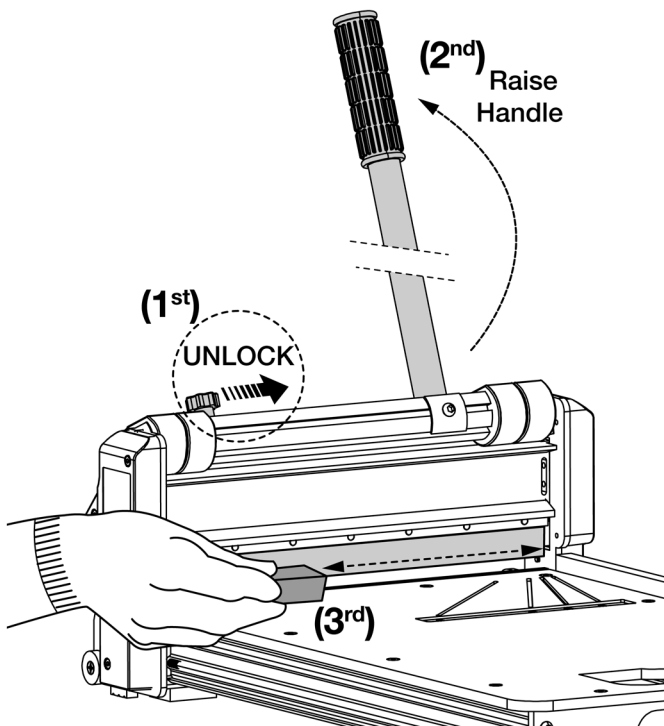

**NOTE:** Keep blade sharp and clean for better performance. Sharpening the blade by a qualified professional is recommended.

### To Replace the Blade:

- Move Lock Knob toward Handle to unlock.
- Raise Handle.
- Use the included 4mm Hex Wrench [9] to remove screws with washers.
- Replace worn blade with a new one.
- Reinstall screws and washers. Use 4mm Hex Wrench [9] to tighten screws.

Figure 10

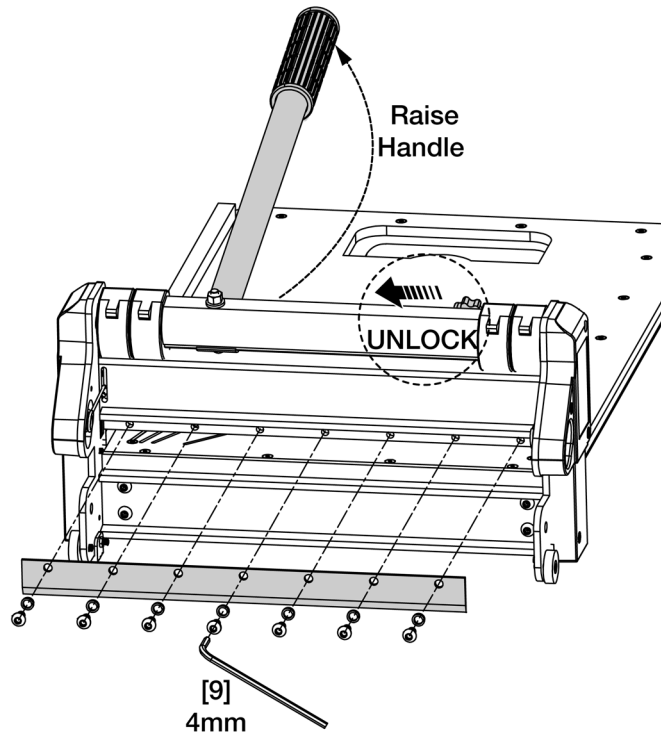

## GENERAL MAINTENANCE

#### **WARNING**

When servicing, use only identical replacement parts. Use of any other parts may create a hazard or cause product damage.

#### **WARNING**

Keep the Flooring Cutter dry, clean, and free from oil and grease. Always use a clean cloth when cleaning. Never use brake fluids, gasoline, petroleum-based products or any strong solvent to clean the Flooring Cutter. Chemicals can damage, weaken or destroy plastic which may result in serious personal injury.

Visit us on the web at [www.powertecproducts.com](http://www.powertecproducts.com)



Put these instructions and the original sales invoice in a safe, dry place for future reference.

Southern Technologies, LLC • Chicago, IL 60606