

**POWERTEC®**

# Edge Deck Screw Jig



**QUESTION...**

**1-847-780-6120**

**WARNING**

For your own safety, read the tool instruction manual before using any accessory. Failure to heed these warnings may result in serious personal injury and damage to the tool and the accessory.

**SPECIFICATIONS**

Minimum Board Width	3.5"
Maximum Board Width	6"
Deck Spacing	3.5mm, 4.5mm, 5.5mm

**UNPACKING CONTENTS**

**NOTE:** Check for shipping damage. Check immediately whether all parts and accessories are included.

ITEM	DESCRIPTION	QTY
A	Edge Deck Screw Jig (assembled)	1
B	1mm Spacer	2
C	2mm Spacer	2
D	Spacer Screw	4
E	T15 Torx Screw Driver Bit	1

Figure 1 Some Assembly Required

**Items Needed:  
(Not Included)**

- Drill Driver
- Phillips Screwdriver
- Torx Edge Deck Screws

**Note:** Generic type Deck screws will not fit in Jig.

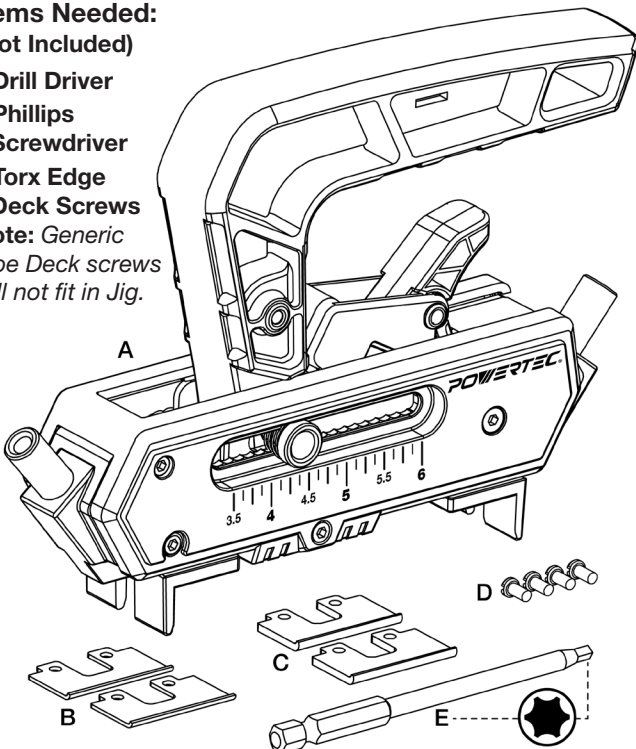

Figure 2 OPERATIONAL FEATURES

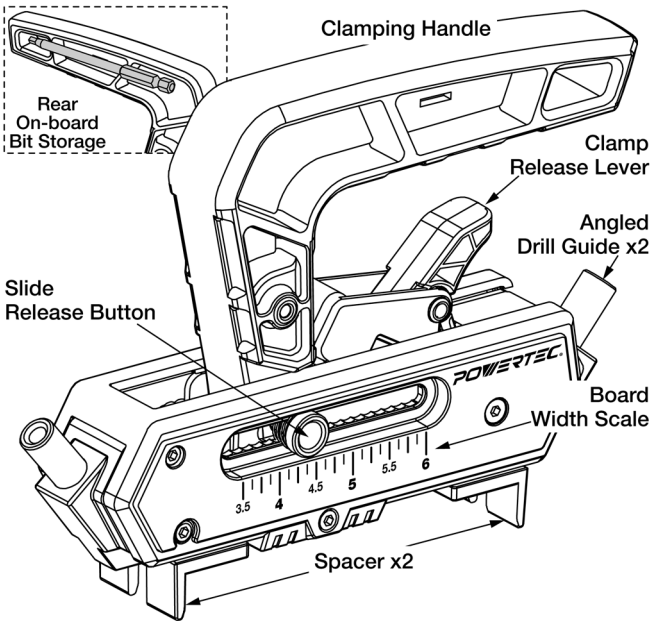

Figure 3 FIGURE CLAMPING WIDTH

Measure decking board.

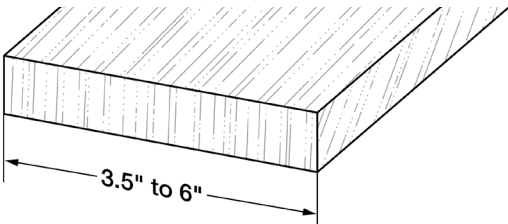

Figure 4 SET CLAMP WIDTH

Hold Handle while pressing Slide Release Button.

Move Button to nearest mark on scale—spacer jaws will expand—move until correct measurement is reached.

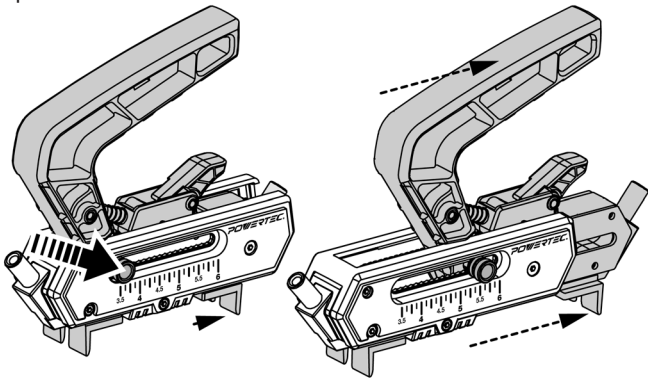
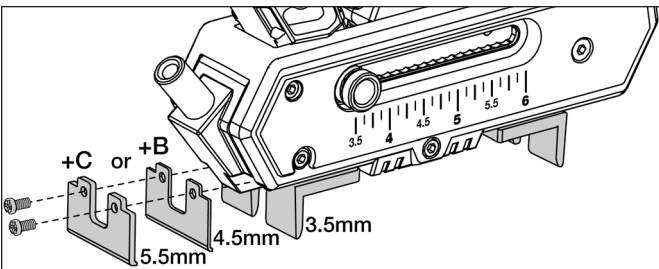

Figure 5 SET UP GAP SPACING

**3.5mm**—Default spacing—using fixed spacer on Jig.

**4.5mm**—Add 1mm Spacer (B) on both sides to achieve this spacing.

**5.5mm**—Add 2mm Spacer (C) on both sides to achieve this spacing.



## Figure 6 CLAMP JIG TO BOARD

Push downward on Handle to clamp Jig to decking board ensuring the Clamp is centered on joist.

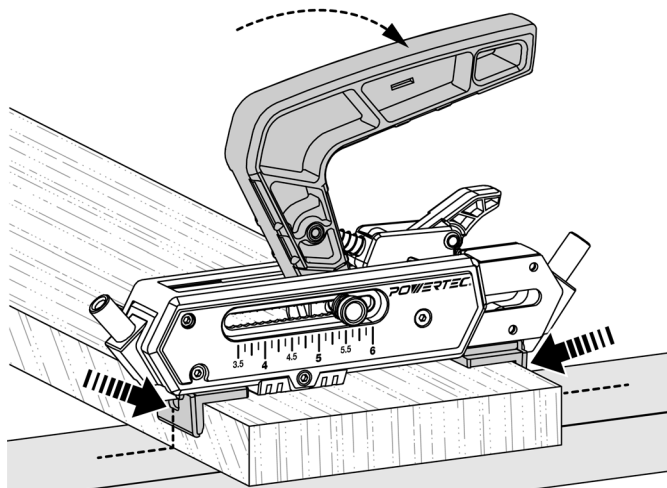

## Figure 7 DROP IN FASTENERS

Drop one screw into each Drill Guide.

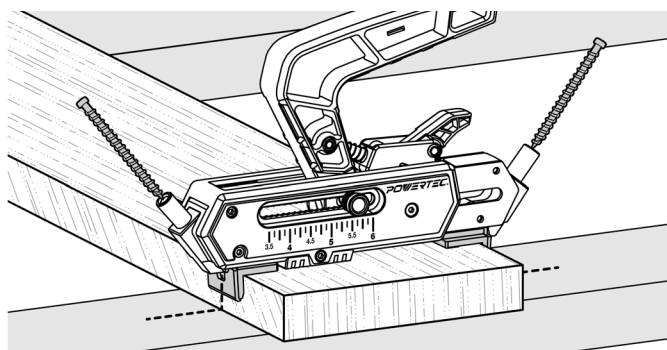

## Figure 8 SECURE DECK BOARD

Attach Driver Bit (E) to drill. Drive screw into board—stop when shoulder of Driver Bit makes contact with Drill Guide.

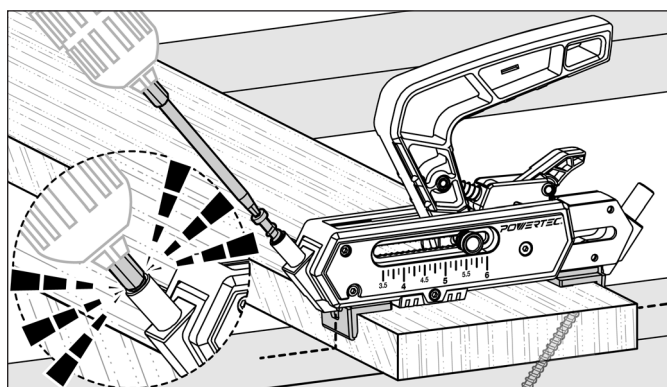

## Figure 9 RELEASE EDGE JIG

Release Jig by pulling up Clamp Release Lever.

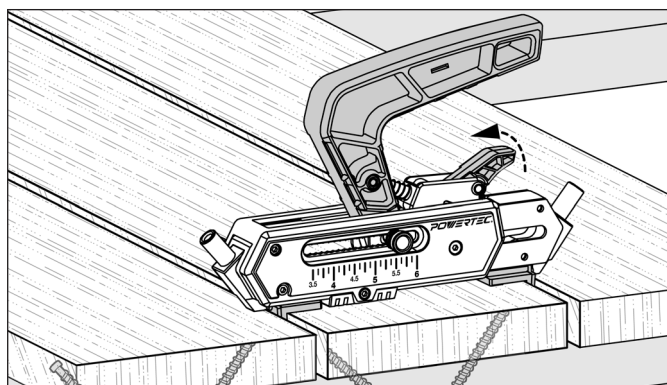

## Figure 10 SECURE END/BUTT JOINT

When finishing an End/Butt joint, thicken the joist (if needed) to ensure the deck screw is located no less than 1" from the end of the board.

**NOTE:** Always center the Jig's Clamp in the center of the joist before fastening the board.

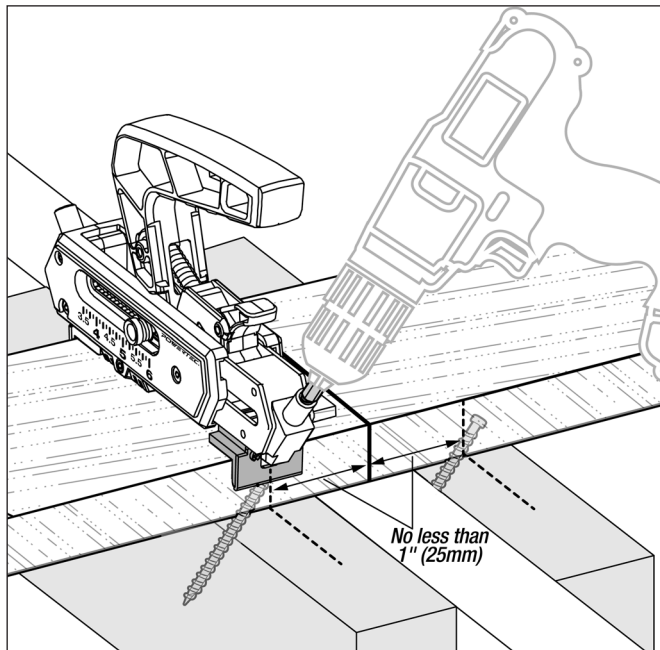

## POWERTEC Companion Products (Sold Separately)

### POWERTEC 72185 Edge Deck Screws

#10 x 2-3/8" T15 Star Drive, 250 Pieces

### POWERTEC 72187 T15 Torx Driver Bit

for Edge Deck Screw Jig, 2 PK

## GENERAL MAINTENANCE

### ⚠ WARNING

When servicing, use only identical replacement parts. Use of any other parts may create a hazard or cause product damage.

### ⚠ WARNING

Keep the Edge Deck Screw Jig dry, clean, and free from oil and grease. Always use a clean cloth when cleaning. Never use brake fluids, gasoline, petroleum-based products or any strong solvent to clean the Edge Deck Screw Jig. Chemicals can damage, weaken or destroy plastic which may result in serious personal injury.

Visit us on the web at [www.powertecproducts.com](http://www.powertecproducts.com)



Put these instructions and the original sales invoice in a safe, dry place for future reference.

Southern Technologies, LLC • Chicago, IL 60606