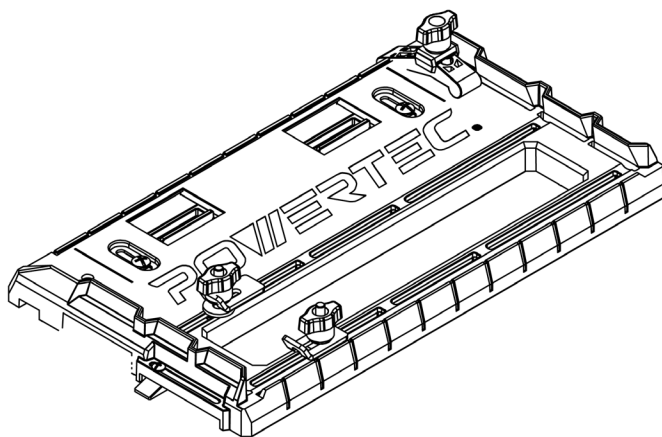

POWERTEC®**Circular Saw Plate****WARNING**

For your own safety, read and understand all warnings and operating instructions before using any tool or equipment.

- Always keep hands clear of blade, cutter, sanding disc/belt.
- Before making adjustments to the circular saw plate, turn off the power, allow the blade to come to a complete stop and unplug the machine.
- Ensure screws and knobs are tightened before using.
- To avoid accidental start-up—Make sure machine is in the “OFF” position before plugging in.

WARNING

Some dust created by power sanding, sawing, grinding, drilling and other construction activities can expose you to chemicals known to the State of California to cause cancer, birth defects or other reproductive harm.

Some examples of these chemicals are:

- Lead from lead-based paints.
- Crystalline silica from bricks and cement and other masonry products.
- Arsenic and chromium from chemically-treated lumber.

NOTE: Your risk from these exposures varies, depending on how often you do this type of work. To reduce your exposure to these chemicals: work in a well ventilated area and work with approved safety equipment. Always wear OSHA/NIOSH approved, properly fitting face mask or respirator when using such tools.

SAVE ALL WARNINGS AND INSTRUCTIONS FOR FUTURE REFERENCE

CONTENTS

Examine carton for shipping damage. Check immediately whether all parts and accessories are included. If anything is missing or broken, contact your retailer or call **847-780-6120**.

NOTE: Carefully remove all contents from shipping carton. The shipping carton contains:

ITEM	DESCRIPTION	QTY
A	Base Plate	1
B	Rail Fence	1
C	Adjustable Guide	2
D	Clamping Bracket	2
E	Hold Down Clamp	1
F	Pivot	1
G	Knobs 1/4"-20	3
H	Screw M4x15L	2
I	Rail Fence Adjustment Screw 1/4"-20 x 1/2" L	2
J	T-Bolt 1/4"-20 x 1-1/2" L	2
K	T-Bolt 1/4"-20 x 2-1/2" L	1
L	Nut 1/4"-20	2
M	Nut M4	2
N	Rubber Washer	2
O	Washer (OD 12mm)	2
P	Washer (OD 19mm)	2
Q	Adhesive Rubber Strip	1

Figure 1

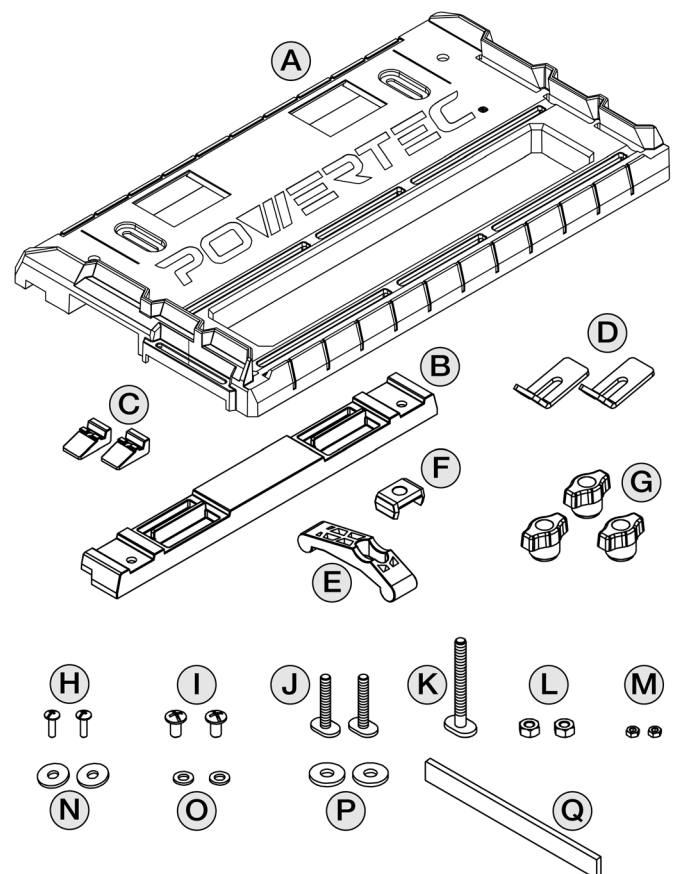

ASSEMBLY

Tools needed: Phillips® screwdriver (not included)

Attach Rail Fence to Plate:

- Insert Adjustment Screws (I) through OD 12mm Washers (O) into holes in Plate (A) and Rail Fence (B).
- Thread 1/4" Nuts (L) from bottom of Rail Fence.
- Do not tighten at this time.

Figure 2

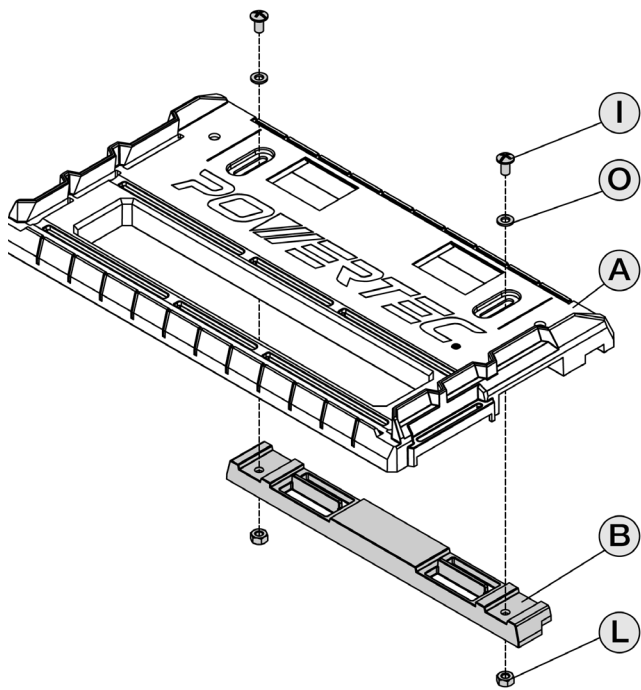

Attach Adjustable Guides to Plate:

- Insert M4 Screws (H) through slot of Plate (A) and hole in Adjustable Guide (C).
- Fasten with M4 Nut (M) from bottom of Guide.
- Repeat on the other side.

Figure 3

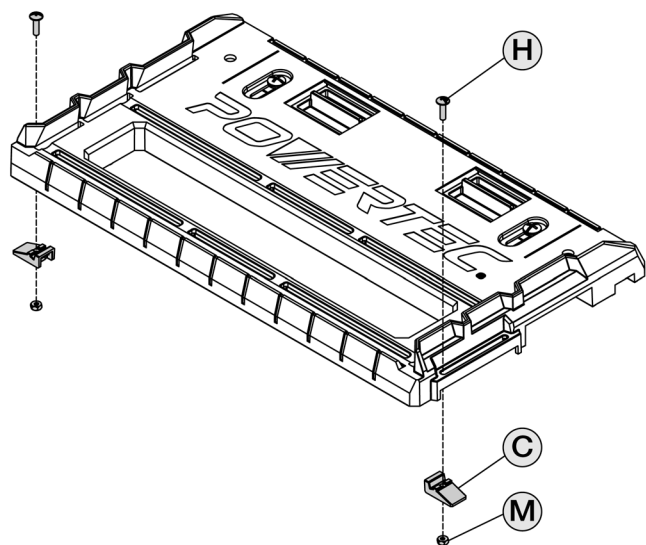

Attach Clamping Brackets to Plate:

- From bottom of rear slots, insert 1-1/2" T-bolts (J), Rubber Washers (N), Clamping Brackets (D), OD 19mm Washers (P) and thread two Knobs (G) on.
- Do not tighten at this time.
- See Figure 5. Slide Clamping Brackets back toward edge of Plate (A) to avoid interference when installing circular saw.

Figure 4

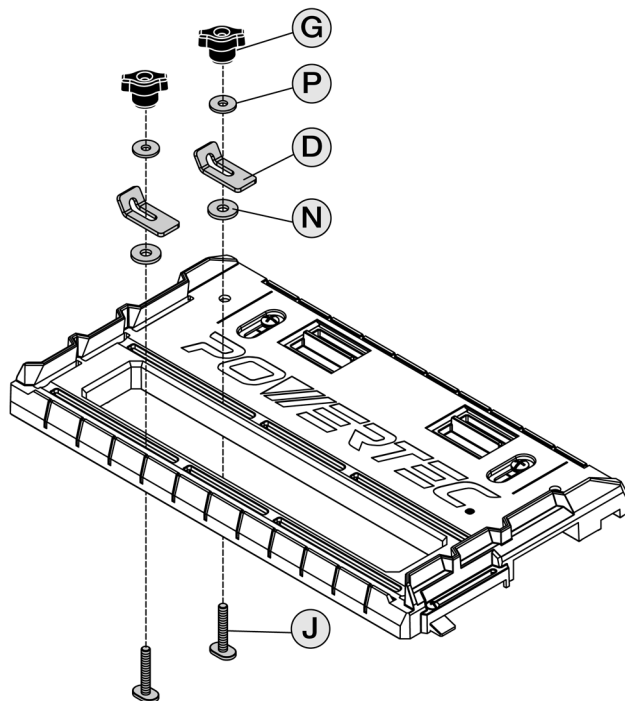

Attach Hold Down Clamp to Plate:

- From bottom, insert 2-1/2" T-bolt (K) through hole in Plate, Hold Down Clamp (E), Pivot (F) and thread Knob (G) on.
- Do not tighten at this time.

NOTE: *At this time, place the short side of Hold Down Clamp (E) inward to avoid interference when installing the circular saw.*

Figure 5

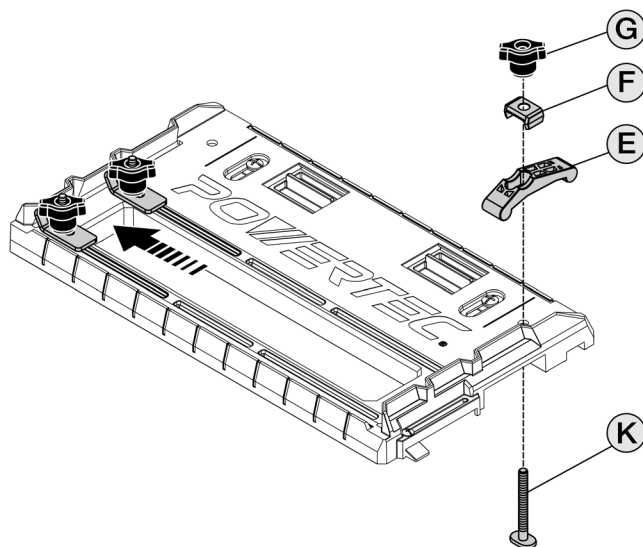

OPERATION

Adjust Rail Fence to Fit Rail Width:

Loosen Rail Fence Adjustment Screws on top.

Figure 6

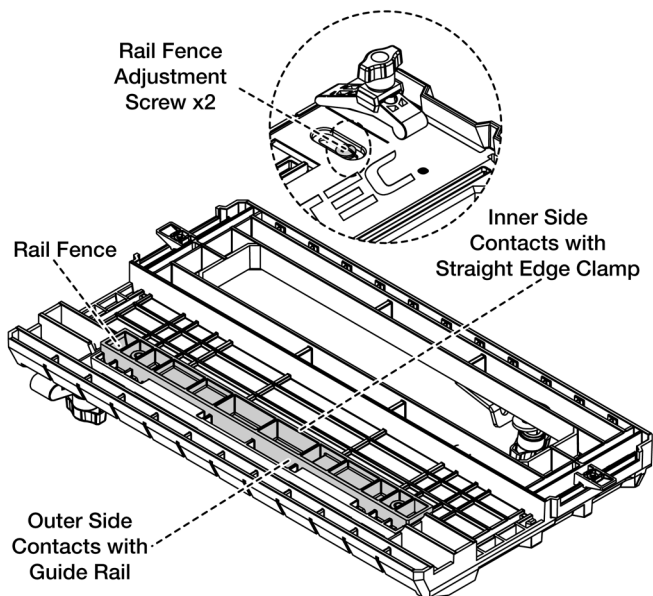

Known Compatible Guide Rails:

The **71993 Plate** is compatible with **POWERTEC 71153 / 71387 / 71870**, as well as Makita®, Festool® and Milwaukee® Style Guide Rails. (Makita is a trademark of Makita Corporation / Festool is a trademark of TTS Tooltechnic Systems AG & Co. KG / Milwaukee is a trademark of Milwaukee Electric Tool Corporation.)

- **Mounting on Guide Rail:** Adjust to flush outer edge of Rail Fence against the guide rail bottom slot.

Figure 7

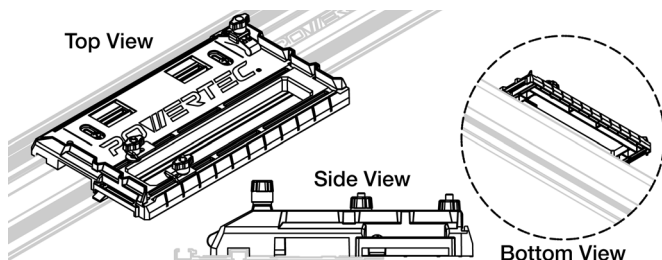

Compatible Straight Edge Clamps:

The **71993 Plate** fits straight edge clamps (such as **POWERTEC 71707**) ranging from 2" to 2-1/2" W x <5/8" H.

- **Mounting on Straight Edge Clamp:** Adjust to flush inner edge of Rail Fence against the side of straight edge clamp.

Figure 8

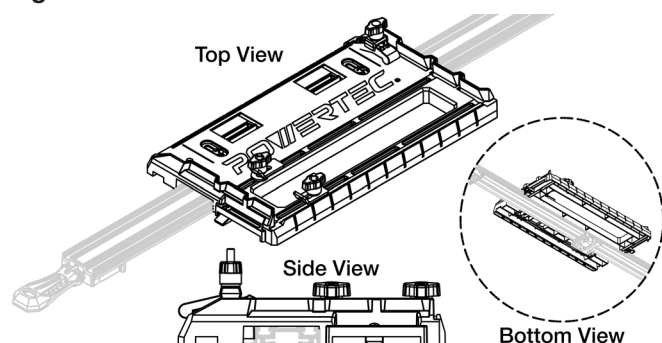

- Ensure the Plate slides smoothly on the guide rail or straight edge clamp. Tighten the Adjustment Screws.

Install Circular Saw onto Plate:

The **71993 plate** is compatible with circular saw base of 12-1/2" L x 6-1/2" W or smaller.

⚠ WARNING

Risk of accidental startup. Turn off the power, and unplug the saw before installation.

- [1] Set **71993 Plate** onto workbench. Place Circular Saw onto Plate—allow blade to pass through blade slot in Plate.

Figure 9

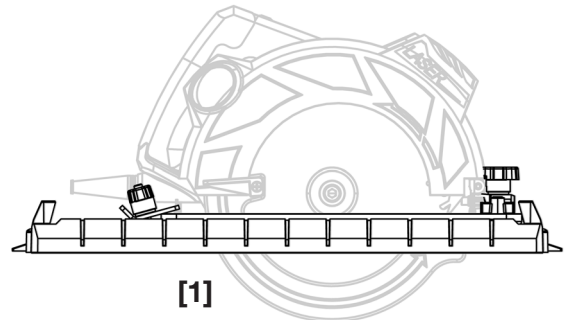

- [2] Push saw base forward and firmly against front fence of Plate.
- [3] Push saw base toward the Plate side and firmly against it.
- [4] Slide both Clamping Brackets forward to hold saw base. Tighten Knobs on Clamping Brackets.

Figure 10

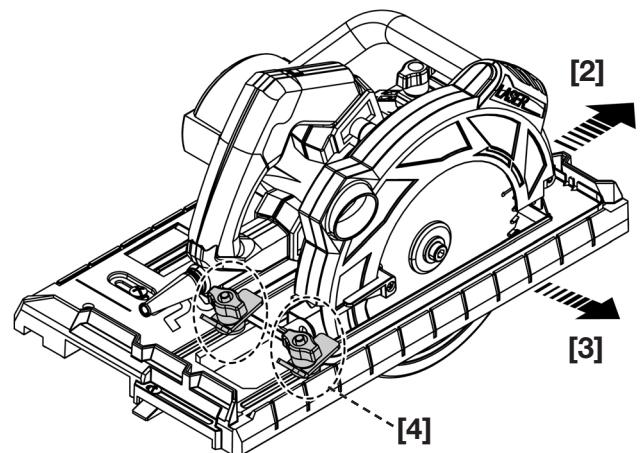

- [5] Adjust Hold Down Clamp to secure the saw base in place. Position according to size of saw base. Tighten the Knob.

Figure 11

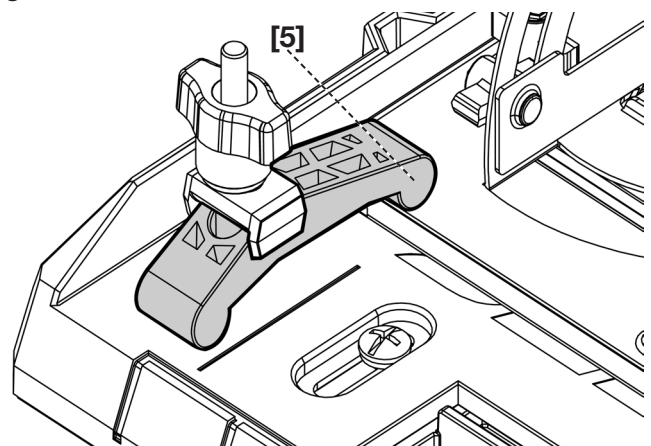

Adjust Clamps: Right or Left Hand Mounting

- Right hand mounting shown.
- Reverse clamping for left hand mounting.

⚠ WARNING

Risk of accidental startup. Before making adjustments, turn off the power, allow the blade to come to a complete stop and unplug the saw.

- Use 2 Clamping Brackets (D) (with the tongue up) to secure saw base to Plate on the rear side.
- Fasten with Knobs (G).

Figure 12

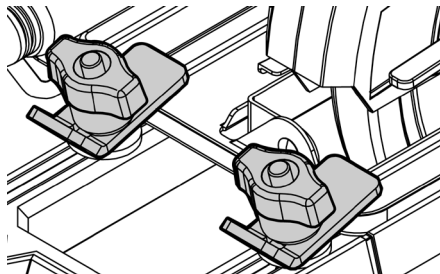

- On side of Plate, use Hold Down Clamp (E) to secure saw base in place.
- Depending on the saw base size—use long or short side of Hold Down Clamp to clamp (Figure 13) or to wedge (Figure 14) the saw base to prevent side movement.

Figure 13

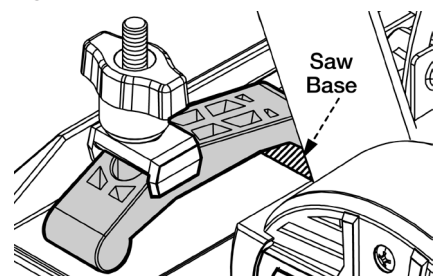

Shown: Clamp long side IN clamping onto saw base to hold in place.

Figure 14

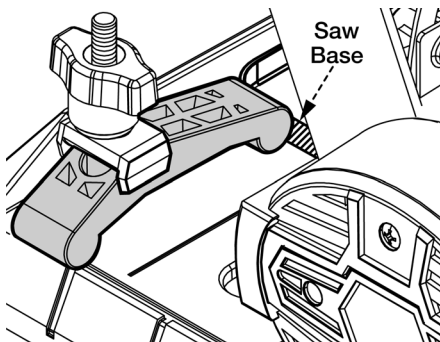

Shown: Clamp long side IN wedged against saw base to hold saw in place.

Note: The Circular Saw Plate can be used with either right hand or left hand saws. Illustrations show installing to a right hand saw. For left hand saws, move clamping brackets and clamp to the opposite end.

Install Rubber Strip: if Needed

- If the front edge of circular saw base is not flat, adhere the included Rubber Strip (Q) to Plate front fence in order to assist with stability.
- If the front edge of saw base is flat and flush against the Plate front fence, store the Adhesive Rubber Strip in a safe place for future use.

Figure 15

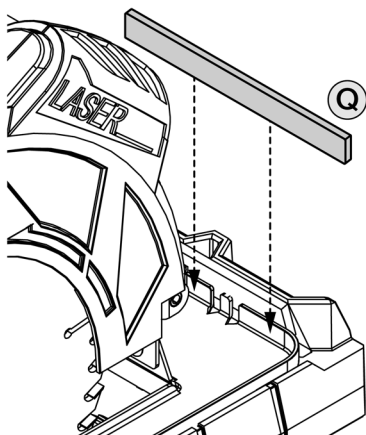

Align Adjustable Guides to Cut Path:

The 71993 Plate is equipped with two Adjustable Guides (C) on both sides.

- Ensure circular saw is firmly installed on Plate.
- Follow all operational instructions of circular saw.
- Use a scrap board for test cut.
- Turn off the power, allow the blade to come to a complete stop. Unplug the saw.
- Loosen screw to adjust Guide. Align left or right edge to the cut path. Tighten the screw.
- Repeat on the other guide.

Figure 16

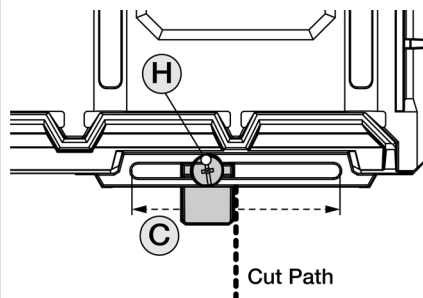
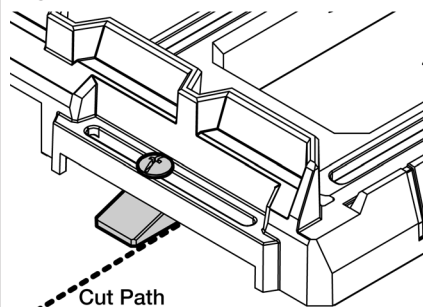

Figure 17



MAINTENANCE

⚠ WARNING

When servicing, use only identical replacement parts. Use of any other parts may create a hazard or cause product damage.

⚠ WARNING

Keep the Circular Saw Plate dry, clean, and free from oil and grease. Always use a clean cloth when cleaning. Never use brake fluids, gasoline, petroleum-based products or any strong solvent to clean the Circular Saw Plate. Chemicals can damage, weaken or destroy plastic which may result in serious personal injury.

Visit us on the web at www.powertecproducts.com



Put these instructions and the original sales invoice in a safe, dry place for future reference.

Southern Technologies, LLC • Chicago, IL 60606