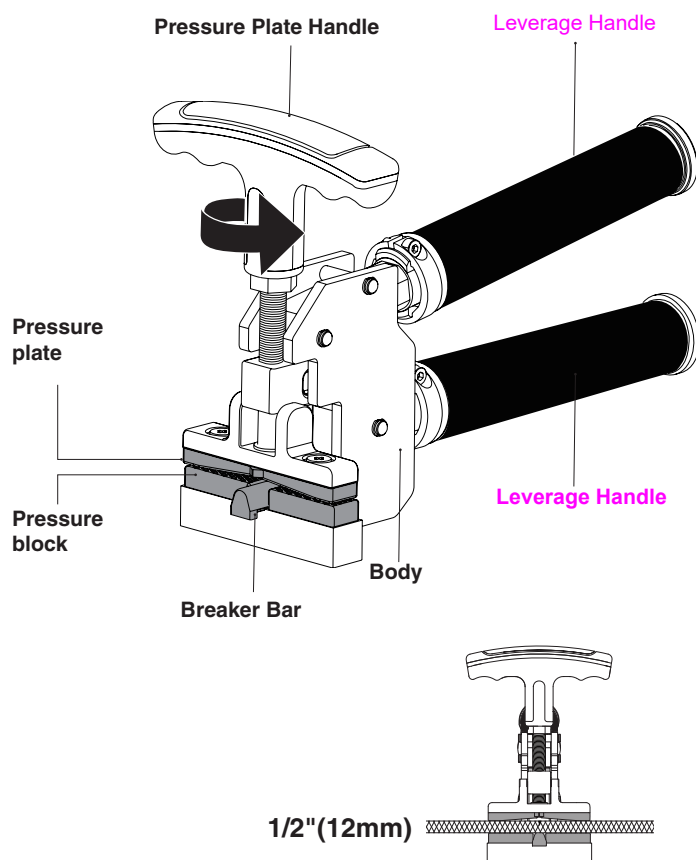
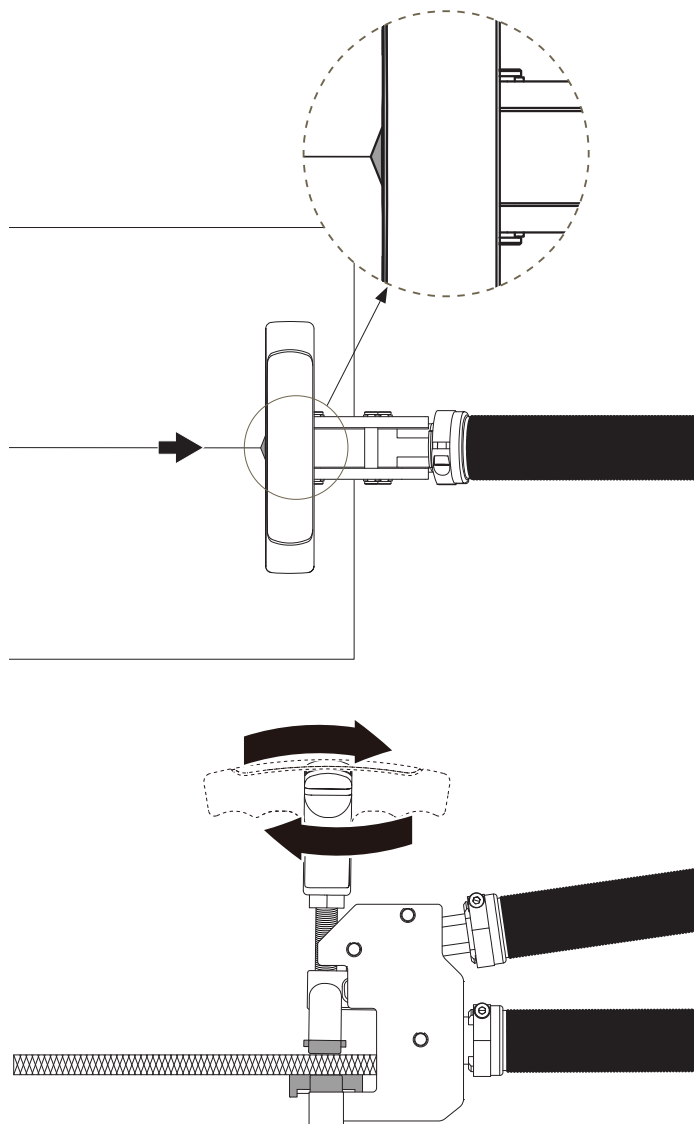

POWERTEC^{PRO}**Large-Format Tile Breaker****Cutting Tile**

After scoring the tile, place it in the tile breaker jaws with the breaker bar aligned directly under the score line. It's important that the two pressure plate arrows are aligned with the scored cutting line. This ensures that pressure is applied evenly and directly over the scored line, allowing for a clean and precise snap.

Next, adjust the tile breaker pressure blocks so that they are positioned about 0.5" to 1" from the edge of the tile. To cut the tile, simply turn the pressure plate handle slowly and clockwise until you hear a subtle click of the tile. You may have to repeat this at each end of the tile, with the snap occurring the second or more times the pressure is applied to the ends of the score line.

**NOTE:**

Always start the break close to each end of the tile first before moving the tile breaker inwards to ensure that the break starts from the edge of the tile.

Visit us on the web at www.powertecproducts.com



Put these instructions and the original sales invoice in a safe, dry place for future reference.

Southern Technologies, LLC
Chicago, IL 60606