

POWERTEC®

48" Manual Tile Cutter

with Laser Guide



⚠ WARNING

For your own safety, read the instruction manual before using any accessory. Failure to heed these warnings may result in serious personal injury and damage to the tool and the accessory.

- Before using the Tile Cutter, read and follow all instructions and safety information provided.
- Always keep hands clear during operation.
- Before making adjustments to the Tile Cutter, ALWAYS verify hands are at a safe distance from the cutter wheel.

SPECIFICATIONS

Maximum Rip Cut..... 48" (1220mm) Tile
 Maximum Diagonal Cut..... 34" (863.6mm) Tile
 Maximum Tile Thickness..... .59" (15mm)

UNPACKING CONTENTS

NOTE: Check for shipping damage. Check immediately whether all parts and accessories are included.

ITEM	DESCRIPTION	QTY
A	Track Rail	1
B	Breaker Bar	1
C	Sliding Handle Assembly	1
D	Auxiliary Support Bracket	2
E	Fence	1
F	Base	1
G	Cutter wheel	1
H	Transport Wheels	2
I	Transport Handle	1
J	Handle Rod	1

Figure 1 Some Assembly Required

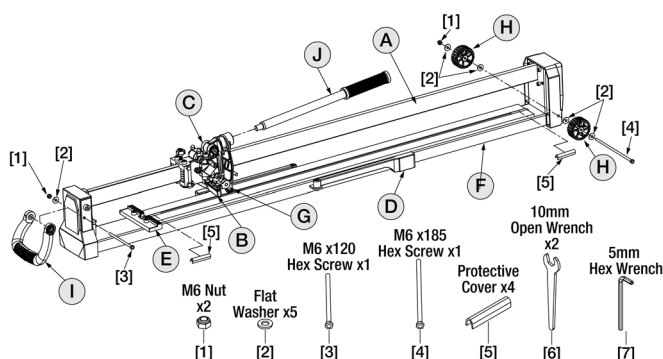

ASSEMBLY

- Thread Handle Rod (J) into Sliding Handle Assembly (C).

Figure 2

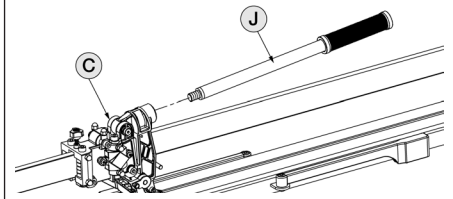

- Attach Transport Handle (I) with M6x120 Hex Screw [3], Washer [2] and M6 Nut [1].

Figure 3

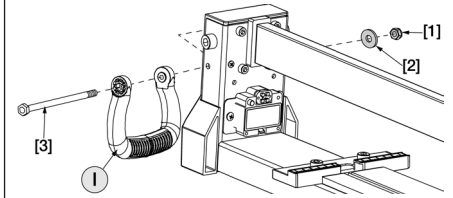

- Mount 2ea. Transport Wheels (H) with M6x185 Hex Screw [4], 4ea. Washers [2] and M6 Nut [1].

Figure 4

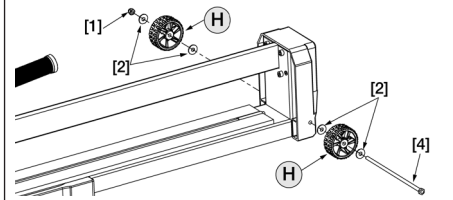

OPERATION

For narrow tile less than 2", or tile thickness 10mm or less, please remove the protective covers. For tile longer than 46" (1170mm), please slide to remove the front and rear protective covers. Store protective covers in a convenient place for future use.

For tile thickness more than 10mm (up to 15mm), please place the protective covers before cutting the tile.

Figure 5

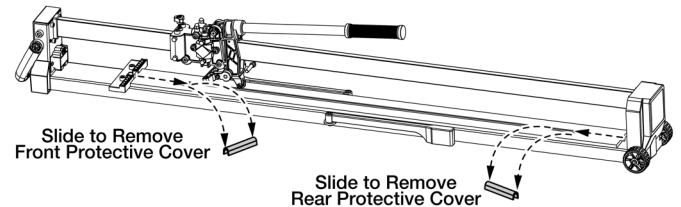

LASER GUIDE

The **POWERTEC 71981** comes with a (red light) laser guide. Requires 2 AAA batteries (not included).

To adjust Laser Guide: Loosen the two Phillips screws. Move the laser guide right or left to adjust the location for alignment—then tighten the screws.

Figure 6

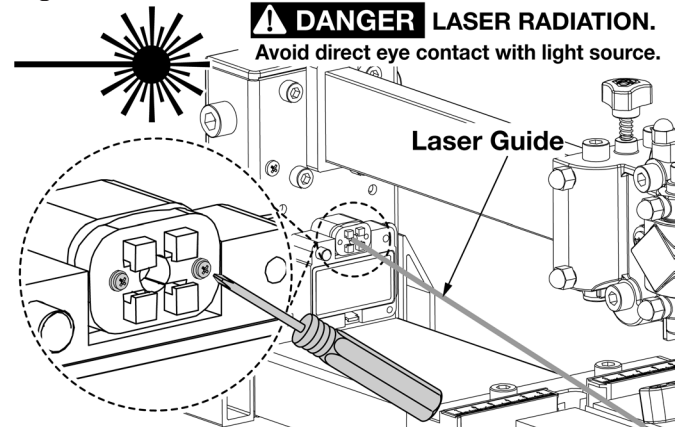

⚠ WARNING

Use of controls or adjustments or performance of procedures other than those specified herein could result in hazardous radiation exposure.

TILE CUTTING

1. Slide handle to the rear of the tile.
2. Place tile flat on base plate, align tile with scoring wheel path for desired cut size, and place tile firmly against fence.
3. Lift the Sliding Handle upward allowing the breaker bar to rotate and hang freely.
4. Swing Breaker Bar forward, away from the cutter so it sets into place in upward position.

Figure 7

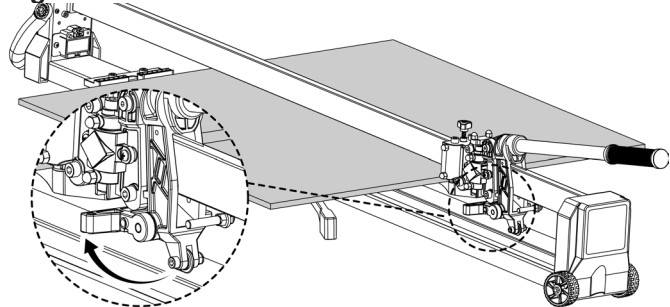

5. With the Sliding Handle fully to the rear of the tile, press down on Sliding Handle allowing cutter wheel to contact the surface of the tile.
6. Using moderate and consistent pressure, move Sliding Handle forward scoring a **continuous** straight line on the surface of the tile. If the movement is not continuous, it will not score properly for the tile to break.

Figure 8

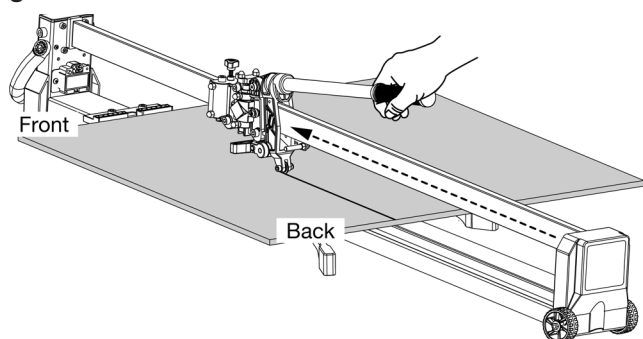

SPLITTING THE TILE

1. When finished with the run, lift the Sliding Handle until breaker bar swings loose.
2. Allow breaker bar to rest at front edge of the tile and push handle downward.
3. The entire run should snap revealing a perfect cut.

NOTE: If tile does not completely break on first try, while holding tile in place, move breaker bar to the back edge of tile and press again. Always break tile from either tile edge and never in the middle of the tile.

Figure 9

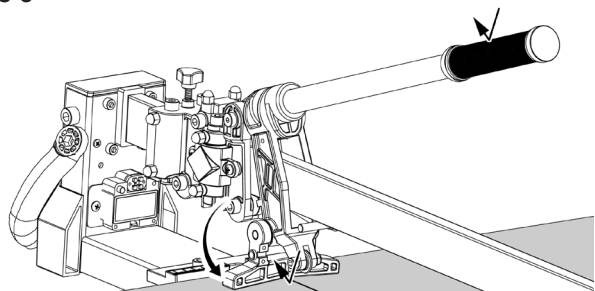

REPLACING THE CUTTER WHEEL

⚠ WARNING

Risk of personal injury. Watch for sharp edge of cutter wheel when making replacement or adjustment.

Figure 10 Locate the Cutter Wheel

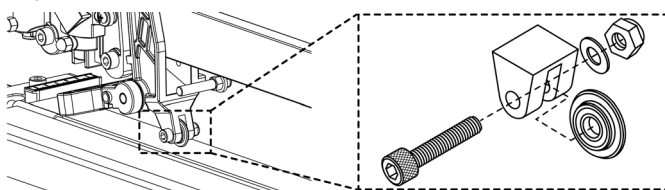

Step 1

Use 5mm Hex Key Wrench [7] and 10mm Open Wrench [6] to loosen bolt and nut.

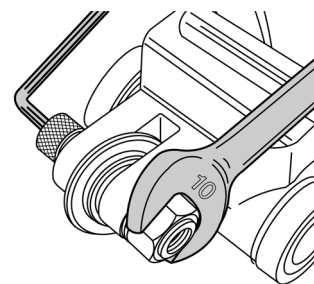

Step 2

Remove the bolt, nut and washer.

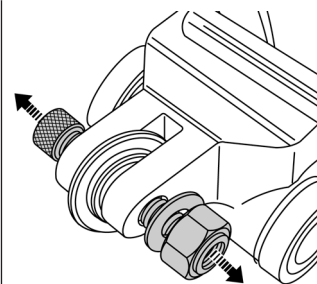

Step 3

Remove worn cutter wheel and replace with new cutter wheel.

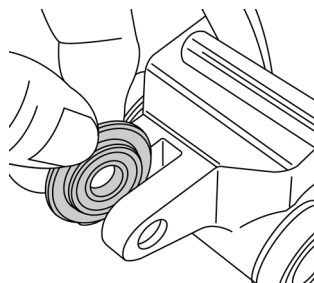

Step 4

Insert the bolt through the holes and cutter wheel. Place washer and the nut onto the bolt and then tighten the nut.

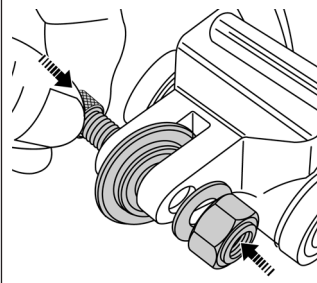

GENERAL MAINTENANCE

⚠ WARNING

When servicing, use only identical replacement parts. Use of any other parts may create a hazard or cause product damage.

⚠ WARNING

Keep the Tile Cutter dry, clean, and free from oil and grease. Always use a clean cloth when cleaning. Never use brake fluids, gasoline, petroleum-based products or any strong solvent to clean the Tile Cutter. Chemicals can damage, weaken or destroy plastic which may result in serious personal injury.

Visit us on the web at www.powertecproducts.com



Put these instructions and the original sales invoice in a safe, dry place for future reference.

Southern Technologies, LLC • Chicago, IL 60606